



Community Building and Leadership in Asia Pacific

2012 EWC/EWCA International Conference

Beijing, China | September 1–3, 2012

Hosted by the East-West Center and the East-West Center Association
in cooperation with the EWCA Beijing Alumni Chapter and Peking University

北京大学英杰交流中心会场平面图

Floor plan of Ying Jie Exchange Center, Peking University

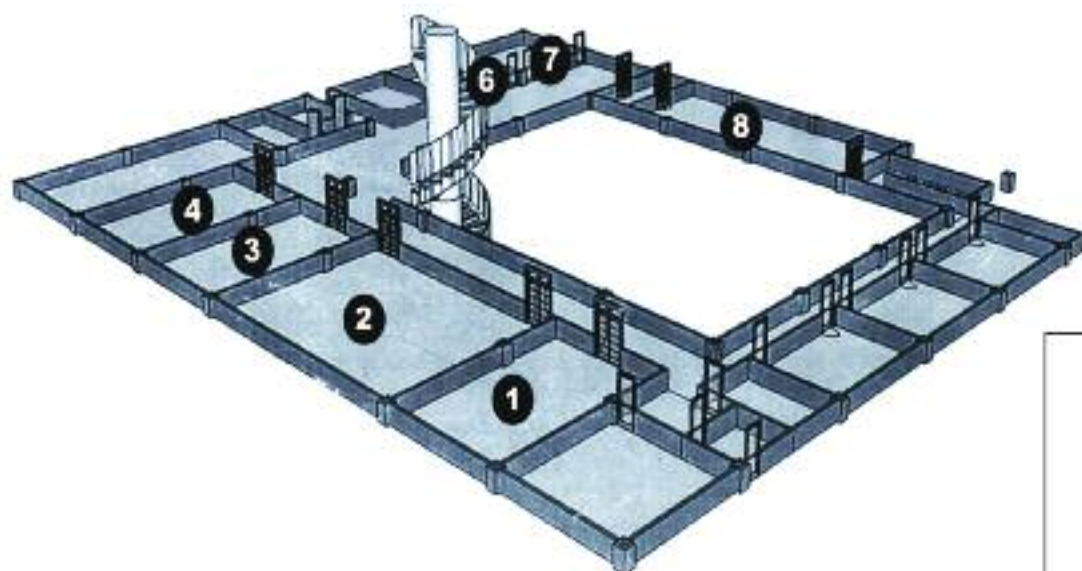

二层
(2nd floor)

- 1. 第一会议室 Room.1
- 2. 第二会议室 Room.2
- 3. 第三会议室 Room.3
- 4. 第四会议室 Room.4
- 5. 第六会议室 Room.6
- 6. 第七会议室 Room.7
- 7. 第八会议室 Room.8

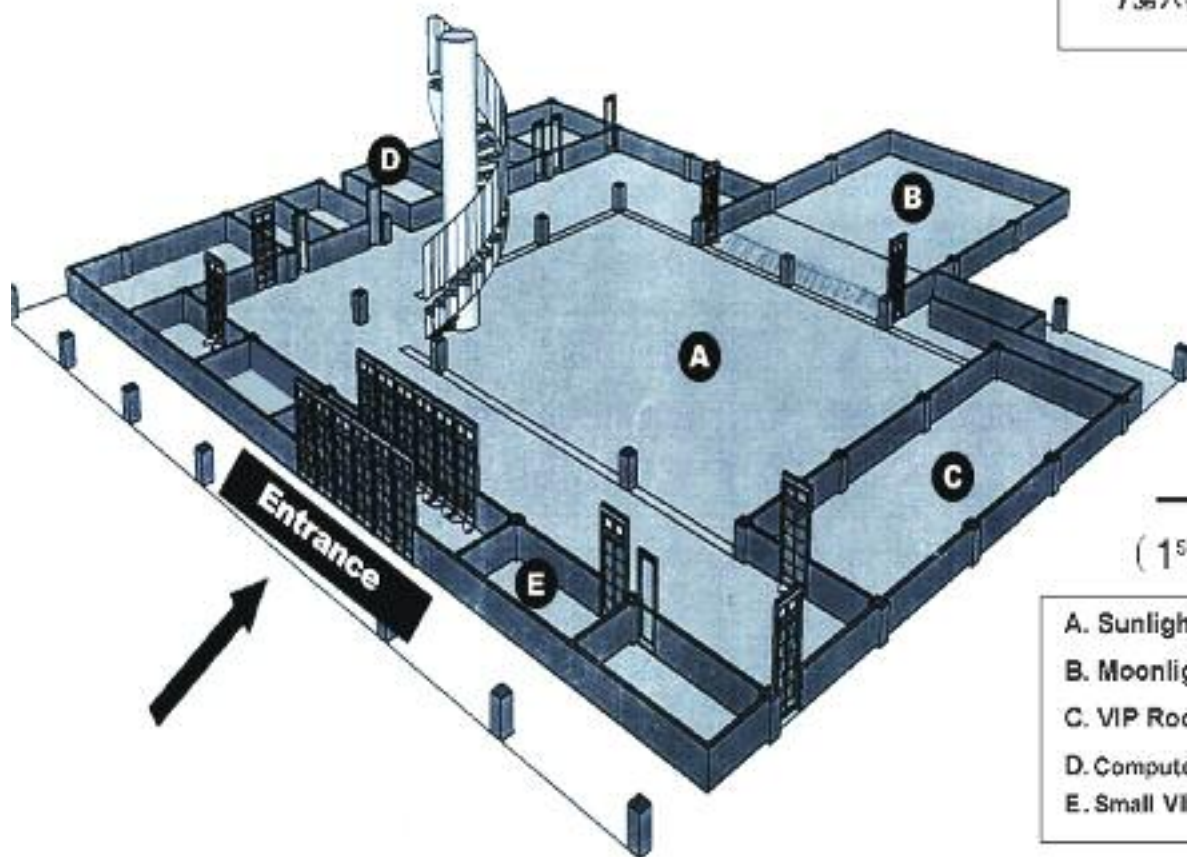

一层
(1st floor)

- A. Sunlight Hall
- B. Moonlight Hall
- C. VIP Room
- D. Computer Room (Room.102)
- E. Small VIP Room

2012 EWC/EWCA International Conference

Beijing, China | September 1–3, 2012

Community Building and Leadership
in Asia Pacific

Contents

| | |
|---|----|
| Welcome Letters | 2 |
| Overview Summary of Conference Schedule | 5 |
| Detailed Conference Schedule | 7 |
| EWC Distinguished Alumni Awards | 14 |
| Presidential Recognition Award | 14 |
| EWCA Outstanding Volunteer Awards | 15 |
| EWCA Outstanding Chapter Awards | 15 |
| Members of Conference Committee | 16 |
| EWCA Executive Board | 16 |
| EWCA Chapter Leaders | 16 |
| Conference Sponsors | 17 |
| EWCA Alumni Scholarship Fund | 18 |
| Conference Participants | 22 |
| Panel Presenters and Moderators | 26 |
| Campus Map of Peking University | 29 |



EAST - WEST CENTER
COLLABORATION • EXPERTISE • LEADERSHIP

September 1, 2012

Warm greetings from Peking University!

On behalf of Peking University, I would like to welcome all of you to Beida (the abbreviation of Peking University in Chinese) and I hope that your stay in Beijing is both rejuvenating and educational.

The collaboration between Beida and the East-West Center (EWC) dates back to decades ago. With strong support and great efforts from both sides, the collaboration have continued to grow and expand over the years, and now Beida and EWC have built long-term cooperation on programs in various fields. It promotes in-depth understanding and mutual respect by enhancing exchanges between the scholars and academic institutions of the two countries. We are very pleased to become the local host for the East-West Center Association Conference, and we look forward to meeting old friends and making new ones.

It's an exciting time for Beida as we continue to internationalize. Our University is confronting a time of many changes and we're encountering these changes during a time of larger global change. I am very glad to see that this year's conference topics touch on most fields where these changes are taking place. I firmly believe that our joint efforts will bring prosperity and happiness to the Asia-Pacific area. Beida will continue to meet and bring inspired people together in conferences like this, in order to ensure the University remains at the cutting edge of internationalization.

Finally, I'd like to thank each of you for attending our conference and bringing your expertise to our gathering. I wish you a pleasant stay in Beijing!



LI Yansong
Vice President
Peking University



LI Yansong



1601 East-West Road
Honolulu, Hawai'i
96848-1601

Tel: 808.944.7103
Fax: 808.944.7106
EastWestCenter.org

Office of the President

September 1, 2012

Dear East-West Center Alumni and Friends,

Welcome to the EWC/EWCA International Conference in Beijing. The 2012 international conference provides an opportunity to learn about the ongoing developments and issues in the Asia Pacific region, learn about new programs and projects at the East-West Center, and reconnect with friends and colleagues.

We wish to especially thank this year's conference committee and our partners at Peking University's Yingjie Exchange Center, who have worked hard to develop an interesting program around the theme "Community Building and Leadership in Asia Pacific." A special recognition is due the Beijing Alumni Chapter, who provided valuable input into the planning process as well. Alumni participation on panels, at poster sessions, and as active audience members will contribute to the overall success of the conference.

The East-West Center is now into its 52nd year. It's hard to believe that it was two years ago that we all gathered in Honolulu to celebrate the Center's Golden Jubilee. The energy and excitement that was generated in Hawai'i continues to inspire us as we move forward. We are continually bolstered by the enthusiasm, support and good wishes of our alumni, and hope that this year's conference will not only allow us to renew friendships, but inspire each of us to build new relationships.

Your support, in addition to the support of the US Congress, private donors, friends in the region, and a strong alumni network has enabled the East-West Center to further advance its mission. Our student program has nearly 600 students, which, despite budget challenges, is a higher number than in previous years. Since the Center was established in 1960, nearly 60,000 people have participated in EWC programs and many of them now hold positions of influence in their communities, their countries, and the world. This network of alumni is a critical element and indicator of the East-West Center's success.

We believe that the Center's mission of strengthening relations and understanding among the peoples and nations of Asia, the Pacific, and the United States is more vital than ever.

Your strong support encourages us to continue. Thank you and aloha,

Charles E. Morrison
President, East-West Center

R. Brian Tsujimura
Chairman, Board of Governors



Charles E. Morrison



R. Brian Tsujimura



1601 East-West Road
Honolulu, Hawai'i
96848-1601

Tel: 808.944.7506
Fax: 808.944.7376
EastWestCenter.org

Associates Office

September 1, 2012

Aloha kākou!

We are pleased to welcome you all on behalf of the East-West Center Association (EWCA), which is now 60,000 alumni strong.

Planning and organizing the conference over the past year has been both a labor of love and a great experience! The EWCA is especially appreciative of the close coordination and great working relationship with our colleagues at Peking University and with our own energetic staff at the Center. This event would not have been possible without the strong support of China's Vice Minister of Education Hao Ping (1991-93 EWC alumnus) and the kokua of the EWCA Chapter in Beijing. Mahalo to all.

We are pleased with the broad diversity of topics reflected in this year's conference. Not only are they relevant to the global community of the Twenty-First Century, but more importantly they are evidence of the world-wide human resources and leadership for excellence that a half-century of EWC culture has produced—namely ourselves! The conference validates the critical relevance and continuing importance of the Center for the present Asia-Pacific Century.

We are here to celebrate, learn, meet old friends, and make new ones. At the same time we encourage each of us to re-commit ourselves to support—and live—the vision of the Center. Finally, let us enjoy this opportunity to discover (or re-discover) the charms and challenges of our host city, Beijing!

e mālama pono (take care of one another),

Ric Trimillos (1962-64)
Outgoing EWCA President

Ned Shultz (1969-71)
EWCA President

Nirendra Maske (1966-68)
EWCA Chair



Ric Trimillos



Edward (Ned) Shultz



Nirendra Maske

Conference Schedule Overview

All sessions for the conference will be held at the Yingjie Exchange Center at Peking University.

FRIDAY, AUGUST 31

1:00 – 4:00 pm **Early Registration Check-in and Information Desk**
open | Yingjie Exchange Center (1st floor lobby area)

SATURDAY, SEPTEMBER 1

8:00 am – 5 pm **Registration Check-in and Information Desk**
open | Yingjie Exchange Center (1st floor lobby area)

8:00 am – 5 pm **Computer Room** open | Room 102 (1st floor)

8:00 am – 5 pm **Secretariat Room** open | Room 6 (2nd floor)

8:00 am – 5 pm **Hospitality Room** open | Room 7 (2nd floor)

9:00 – 10:30 am **Opening Ceremony**
Yingjie Exchange Center, Sunlight Hall (1st floor)

Welcoming Remarks

Yansong Li, Vice President, Peking University
R. Brian Tsujimura, Chairman, East-West Center Board of Governors

Welcome Address

The Honorable Hao Ping, Vice Minister of the Ministry of Education, People's Republic of China

EWCA Report

Edward "Ned" Shultz, Dean, School of Pacific and Asian Studies, University of Hawai'i at Mānoa and President, EWCA Executive Board

Keynote Address

The Honorable Gary Locke, United States Ambassador to the People's Republic of China
MC: Karen Knudsen, Director, Office of External Affairs, East-West Center

10:30 – 11:00 am **Coffee Break** (1st floor lobby area)

11 am – 12:00 pm **Plenary Panel**
Contemporary China
Sunlight Hall (1st floor)

12:00 – 1:30 pm **Lunch at Nongyuan Restaurant**
on Peking University (PKU) campus, location #2 on the PKU map. You will need your lunch ticket (included behind your name badge) to get your lunch.

1:30 – 2:30 pm **Award Presentation Ceremony**
Sunlight Hall (1st floor)

2:30 – 3:00 pm **Coffee Break and Poster Session Presentation**
Yingjie Exchange Center (1st floor lobby area)

POSTER SESSION PRESENTATIONS



PHOTO: CANARY WU

3:00 – 4:30 pm **Concurrent Panel Sessions**

Representing and Presenting Music in 'Chinese' Contexts | Room 1 (2nd floor)

Building a Supportive Legal Framework for Philanthropy in CHINA: Why Does It Matter?
Room 2 (2nd floor)

Chinese Students Abroad | Room 3 (2nd floor)

Regional Security in Asia Pacific | Room 4 (2nd floor)

Economic Development:

Macro and Micro Perspectives | Room 8 (2nd floor)

Community Building to Address Regional Health Concerns | VIP Room (1st floor)

Lessons Learned from Two Decades of Rapid Change in Asia Pacific Higher Education
Moonlight Hall (1st floor)

4:30 – 6:00 pm **Concurrent Panel Sessions**

Empowering Health and Family Wellness
Room 1 (2nd floor)

From Vision to Action: Building Student Capacity for Today's Knowledge Economy and Society
Room 2 (2nd floor)

Cultural Approaches to Biodiversity
Room 3 (2nd floor)

Looking to Technology for Sustainable Solutions
Room 8 (2nd floor)

Cultural Representation through Cross-Cultural Performance | VIP Room (1st floor)

Different Roads to Governance Reform in Asia Moonlight Hall (1st floor)

7:00 pm

Welcome Reception and Cultural Presentation

Yingjie Exchange Center, Sunlight Hall (1st floor)
Hosted by the EWC/EWCA and the University of Hawai'i

CONFERENCE SCHEDULE OVERVIEW

continued

SUNDAY, SEPTEMBER 2

- 8:00 – 11:00 am **Registration Check-in and Information Desk**
open | Yingjie Exchange Center (1st floor lobby area)
- 8:00 – 11:00 am **Computer Room** open | Room 102 (1st floor)
- 8:00 – 11:00 am **Secretariat Room** open | Room 6 (2nd floor)
- 8:00 – 11:00 am **Hospitality Room** open | Room 7 (2nd floor)
- 9:00 am **Announcements**
- 9:00 – 10:30 am **Plenary Panel**
Priorities in US-Asia Policy | Sunlight Hall (1st floor)
- 10:30 – 11:00 am **Coffee Break and Poster Session**
(1st floor lobby area)
- 11 am – 12:30 pm **Concurrent Panel Sessions**
*Glimpses of Women in Asia:
Interdisciplinary Perspectives* | Room 1 (2nd floor)
*Higher Education:
It is Never Quite What it Seems to be!*
Room 2 (2nd floor)
Technology in 21st Century Education
Room 3 (2nd floor)
*Asia-Pacific Multilateralism:
The Persistence of Older Issues
in New Frameworks* | Room 4 (2nd floor)
WORKSHOP –
*Community Building with Four Treasures:
Chinese Ink, Brush, Xuan Paper, and Stone*
Room 8 (2nd floor)
*The Universal Language of Sports:
Community Building in the Asia Pacific Region*
VIP Room (1st floor)
*Regional Cooperation and Conflict Reduction
in East Asia* | Moonlight Hall (1st floor)
- 12:30 – 1:30 pm **Lunch at Nongyuan Restaurant**
on Peking University (PKU) campus, location #2
on the PKU map. You will need your lunch ticket
(included behind your name badge) to get your lunch.
- 1:30 – 6:30 pm **Half-Day Tour to either
The Great Wall or The Forbidden City**
(included in registration fee).
Please bring your half-day tour ticket with you.
Meet at the entrance of the Yingjie Exchange Center
(conference venue).
- 6:30 pm Return to PKU
Open Evening

MONDAY, SEPTEMBER 3

- 8:00 – 11:00 am **Registration Check-in and Information Desk**
open | Yingjie Exchange Center (1st floor lobby area)
(11 am – 3:30 pm in Secretariat Room, Room 6, 2nd floor)
- 8 am – 3:30 pm **Computer Room** open | Room 102 (1st floor)
- 8 am – 3:30 pm **Secretariat Room** open | Room 6 (2nd floor)
- 8 am – 3:30 pm **Hospitality Room** open | Room 7 (2nd floor)
- 9:00 am **Announcements**
- 9:00 – 10:30 am **Plenary Panel**
Women in Asia Pacific Community Building
Sunlight Hall (1st floor)
- 10:30 – 11:00 am **Coffee Break and Poster Session**
(1st floor lobby area)
- 11 am – 12:30 pm **Concurrent Panel Sessions**
*Reforming Cambodian Education
through El Sistema* | Room 1 (2nd floor)
Innovation in Higher Education | Room 2 (2nd floor)
*People to People Relation and
Information Technology* | Room 3 (2nd floor)
Justice and Rule of Law | Room 4 (2nd floor)
*Nature Conservation in China: Balancing Protection
and Development* | Room 8 (2nd floor)
*Addressing Diversity, Vulnerability
and Social Justice* | VIP Room (1st floor)
*Five Teachings in China: A Globally Significant
Local Knowledge for the 21st Century*
Moonlight Hall (1st floor)
- 12:30 – 1:30 pm **Lunch at Nongyuan Restaurant**
on Peking University (PKU) campus, location #2
on the PKU map. You will need your lunch ticket
(included behind your name badge) to get your lunch.
- 1:30 – 3:00 pm **Plenary Panel**
The Changing East-West Center
Sunlight Hall (1st floor)
- 3:00 – 3:30 pm **Coffee Break** (1st floor lobby area)
- 3:30 – 4:30 pm **EWCA Alumni Membership Meeting**
Open to all conference participants
Yingjie Exchange Center, Sunlight Hall (1st floor)
- 5:30 pm Buses leave for Aloha Banquet
at the Four Points by Sheraton Beijing
(Tower 1, No. 25 Yuandan Road, Haidian District)
Meet at the entrance of the Yingjie Exchange Center
(conference venue).
- 6:30 – 9:00 pm **Farewell/Aloha Banquet
including Alumni Talent Show**
Four Points by Sheraton Beijing
- 9:30 pm Buses leave to go back to PKU

Detailed Conference Schedule

All sessions for the conference will be held at the Yingjie Exchange Center at Peking University.

FRIDAY, AUGUST 31

1:00 – 4:00 pm **Early Registration Check-in and Information Desk**
open | Yingjie Exchange Center (1st floor lobby area)

SATURDAY, SEPTEMBER 1

8:00 am – 5 pm **Registration Check-in and Information Desk**
open | Yingjie Exchange Center (1st floor lobby area)

8:00 am – 5 pm **Computer Room** open | Room 102 (1st floor)

8:00 am – 5 pm **Secretariat Room** open | Room 6 (2nd floor)

8:00 am – 5 pm **Hospitality Room** open | Room 7 (2nd floor)

9:00 – 10:30 am **Opening Ceremony**
Yingjie Exchange Center, Sunlight Hall (1st floor)

Welcoming Remarks

Yansong Li, Vice President, Peking University
R. Brian Tsujimura, Chairman, East-West Center Board of Governors

Welcome Address

The Honorable Hao Ping, Vice Minister of the Ministry of Education, People's Republic of China

EWCA Report

Edward "Ned" Shultz, Dean, School of Pacific and Asian Studies, University of Hawai'i at Mānoa and President, EWCA Executive Board

Keynote Address

The Honorable Gary Locke, United States Ambassador to the People's Republic of China

MC: Karen Knudsen, Director, Office of External Affairs, East-West Center

10:30 – 11:00 am **Coffee Break** (1st floor lobby area)

11 am – 12:00 pm **Plenary Panel**

Contemporary China

Sunlight Hall (1st floor)

Moderator: **CHARLES E. MORRISON**, President, East-West Center

FRED HU, Chairman, Primavera Capital Group
"China and the Macro-economy"

JISI WANG, Dean, School of International Studies, Peking University (invited)
"China's Attitude Toward the World"



PHOTO: KEN MARSHALL

12:00 – 1:30 pm **Lunch at Nongyuan Restaurant**
on Peking University (PKU) campus, location #2 on the PKU map. You will need your lunch ticket (included behind your name badge) to get your lunch.

1:30 – 2:30 pm **Award Presentation Ceremony**
Sunlight Hall (1st floor)

2:30 – 3:00 pm **Coffee Break and Poster Session Presentation**
Yingjie Exchange Center (1st floor lobby area)

POSTER SESSION PRESENTATIONS

JUNKO ITOKAZU, Director, NPO Okinawa Language Center, JAPAN

"Community Building and Leadership in Asia Pacific"

MOMOYO SHIBUYA, Associate Professor, Saitama University, JAPAN (co-author **KAORU KANAI**)

"Community Inclusion and Well-Being Enhancement of Vulnerable Groups in the City: A Case of Tokyo Metropolitan Area"

YEN-KYUN WANG, Visiting Professor, Hoseo University, REPUBLIC OF KOREA

"Experience of and Lessons from the Financial Crises in Korea"

CINDY CHU, Professor, Hong Kong Baptist University, HONG KONG

"History of Contemporary China with Particular References to the Post-1978 Period"

TERUYUKI KUME, Professor, Rikkyo University, JAPAN and **YOKO MATSUDA**, Professor, University of Hyogo, JAPAN

"Role of NPO in Recovery Support for Foreign Residents after the Great Hanshin-Awaji Earthquake: A Case Study of Takatori Community Center in Kobe, Japan"

CHAUDHARY IMRAN SARWAR, Creative Researcher, Mixed Reality University, PAKISTAN

"Self-Quantification Strategies for Leadership Development"

DETAILED CONFERENCE SCHEDULE

Saturday, September 1 continued

3:00 – 4:30 pm **Concurrent Panel Sessions**

Room 1
(2nd floor)

Representing and Presenting Music in 'Chinese' Contexts

Chair/Moderator: **RICARDO TRIMILLOS**

FREDERICK LAU, PhD, University of Hawai'i, USA
"Singing as Collective Memory: Chinese Choir in the Diaspora"

RICARDO TRIMILLOS, Immediate Past President, EWCA Executive Board, USA

"Purveyors of the 'Occidental' and 'Oriental': Music Activity among the Chinese of Kota Kinabalu, Sabah, Malaysia"

MIN WANG, Professor, Xiamen University, MAINLAND CHINA

"American Music in China's Academic and Public Circles"

Room 2
(2nd floor)

Building a Supportive Legal Framework for Philanthropy in CHINA: Why Does It Matter?

Chair: **CAROL FOX**, Director for Special Projects, East-West Center, USA

Moderator: **ZHENYAO WANG**

JINPING JIN, Director, Nonprofit Organization Law Research Center, Peking University, MAINLAND CHINA

MARK SIDEL, Doyle-Bascom Professor of Law, University of Wisconsin-Madison, USA

ZHENYAO WANG, President, China Philanthropy Research Institute, MAINLAND CHINA

Last year's "China Red Cross-Guo Meimei" scandal did severe damage to China's philanthropic sector. Behind the crisis of trust is the urgent need for innovation and reform, reflecting the rapid growth of philanthropy in China and the corresponding increase in expectations for the sector. New regulations on foundations and a charity law are under discussion by the State Council and the Ministry of Civil Affairs and being carefully observed. The China-US Strategic Philanthropy Partnership (CUSP) — launched in August, 2011 at an EWC Workshop — resulted in the formation of a CUSP Secretariat and five Working Groups, each co-chaired by a Chinese and a US expert, and focused on a key issue: Legal Framework, Standards & Accountability, Capacity Building, Social Enterprise, and Support Organizations.

Room 3
(2nd floor)

Chinese Students Abroad

Chair/Moderator: **SHANGBO LI**

SHANGBO LI, Assistant Professor, J.F. Oberlin University, JAPAN

"Who Will Be the Beneficiary?: the New Trends in the International Mobility of Chinese Students"

KATHERINE RATLIFF, Associate Professor, University of Hawai'i, USA

"Immigration, Culture, and Mentorship: How an Immigrant Chinese Adolescent Navigates Conflicting Paradigms in the American School System"

JING XU, PhD Candidate, University of California, Los Angeles, USA

"The Continent Drifted: The Study-abroad Motivations of Chinese Singletons and Their First Year Experience at UCLA"

Room 4
(2nd floor)

Regional Security in Asia Pacific

Chair/Moderator: **MARTHA SMITH-NORRIS**

SITI DAULAH KHOIRIATI, Gadjah Mada University, INDONESIA

"Japan's Relations with Indonesia in the Post Cold War: Facing the Challenge of China's Approach Toward Indonesia"

STIG LINDBERG, PhD Candidate, Kyoto University, JAPAN
"Kagawa's Assessment of Oriental Religion and Philosophy as Presented during the Postwar Occupation of Japan"

MARTHA SMITH-NORRIS, Associate Professor, University of Saskatchewan, CANADA

"Negotiating a Cold War Treaty in the Pacific: The United States and the Compact of Free Association"

Room 8
(2nd floor)

Economic Development: Macro and Micro Perspectives

Chair/Moderator: **DONGHYUN KIM**

DONGHYUN KIM, Graduate Student, New York University, USA

"Seeking a Way towards Sustainable Economic Development In Asia-Pacific: Ensemble of Growth, Distribution, and Education"

WON NYON KIM, Professor, Korea University, REPUBLIC OF KOREA

"The Effect of Tobacco Price and Anti-Smoking Policy Budgets on Smoking Prevalence in Korea"

VIP Room
(1st floor)

Community Building to Address Regional Health Concerns

Chair/Moderator: **VICKI SHAMBAUGH**

PATRICK COOLEN, Eldercare Consultant, USA and **PHYLLIS COOLEN**, USA

"Community Building and Leadership in Asia Pacific: Identifying and Supporting Culturally Sensitive Palliative Care Models for End-of-Life Care"

NANCY LEWIS, Director, Research Program, East-West Center, USA

"Addressing Health Challenges in Asia and the Pacific: Research at the East-West Center"

VICKI SHAMBAUGH, Director, Research and Development, Pacific Health Research and Education Institute, USA (co-author **DEW-ANNE LANGCAON**)

"Technology Enabled Aging at Home"

Moonlight Hall
(1st floor)

Lessons Learned from Two Decades of Rapid Change in Asia Pacific Higher Education

Chair/Moderator: **DEANE NEUBAUER**

MOLLY N.N. LEE, Programme Specialist, UNESCO Asia and the Pacific Regional Bureau for Education in Bangkok, MALAYSIA

WANHUA MA, Professor, Graduate School of Education, Peking University, MAINLAND CHINA

DEANE NEUBAUER, Senior Consultant, Education Program, East-West Center, USA

AHMAD SABIQ, Head of Department of Political Science, Jenderal Soedirman University, INDONESIA
"Reform in Indonesian Public Universities: on the Way to Autonomy"

DETAILED CONFERENCE SCHEDULE

Saturday, September 1 continued

4:30 – 6:00 pm **Concurrent Panel Sessions**

Room 1
(2nd floor)

Empowering Health and Family Wellness

Chair/Moderator: **RAJESH AGGARWAL**, Associate Professor, Centre for Research in Rural and Industrial Development, INDIA

ATIF IKRAM BUTT, PhD Fellow, Ruhr University Bochum, GERMANY

“Ulama as Agents for Development Communication?”

AZADEH DAVARI, Leadership and FNS Trainer and Researcher, The Leadership Group, IRAN and

ARASH RASHIDI, Research Assistant Professor, National Nutrition and Food Technology Research Institute, IRAN (co-author TED BAARTMANS)

“Iranian Food and Nutrition Leadership Program (IFNLP): A Global Perspective, A Local Initiative”

AGUNG MUNINJAYA, Director, The Center of Health Services Management, Udayana University, INDONESIA
“Health Seeking Behavior among Pregnant Mothers in the Village of Pengotan Bangli – Bali”

Room 2
(2nd floor)

From Vision to Action: Building Student Capacity for Today's Knowledge Economy and Society

Chair/Moderator: **NAMJI STEINEMANN**, Associate Director, Education Program, East-West Center, USA

Panelists to be announced

To succeed as 21st century citizens, workers, and innovators, today's youth will need not only specialized content knowledge, but also critical thinking, problem-solving skills, and creativity; information and media literacy; and interpersonal and collaboration skills. Education that prepares students with such knowledge and skills make a profound difference for societies and for the next generation of learners. This discussion will feature a panel of international educational leaders who will share insights into effective practices that translate vision for 21st century education into action in terms of classroom instruction, real-world learning opportunities, and meaningful assessments to build student capacity while offering a forum for dialogue about best practices.

Room 3
(2nd floor)

Cultural Approaches to Biodiversity

Chair/Moderator: **JEFFREY DIPPMAN**

SUNITA CHAUDHARY, Research Associate, International Centre for Integrated Mountain Development, NEPAL (co-authors **KRISHNA PRASAD OLI** and **GOPAL S. RAWAT**)

“Managing Biodiversity in Kailash Sacred Landscape: A Bio-Culturally Rich Transboundary Landscape in China, India and Nepal”

JEFFREY DIPPMAN, Associate Professor, Central Washington University, USA

“Contemporary Daoist Approaches to Environmental Preservation”

MUHAMMAD IBRAHIM, PAKISTAN

“Effect of Global Warming on Siachen Glacier and Pakistan's Agriculture”

RONNIE LITTLEJOHN, Chair, Department of Philosophy, Belmont University, USA

“Nature as Garden; Man as Gardener: In and Beyond Revisionist Confucianism”

Room 8
(2nd floor)

Looking to Technology for Sustainable Solutions

Chair/Moderator: **SENGODA RAJAMANI**

KARL FROGNER, President & Project Development Head, UB International, USA

“Biochar in Smallholder Sustainable Rural Development for Timely Climate Change Mitigation”

SENGODA RAJAMANI, Chairman, International Union of Environment Commission, INDIA

“Recovery of Water from Domestic & Industrial Waste Water Under Zero Liquid Discharge Concept”

SIVA SAKTHIRAJ RAJAMANI, Climate Change and Sustainability Advisor, Ernst & Young, INDIA

“Sustainable Low-Carbon Growth Trajectory for India”

V. BRUCE J. TOLENTINO, Deputy Director-General, International Rice Research Institute, PHILIPPINES

“Global Rice Situation, Food Security, and Climate Change”

VIP Room
(1st floor)

Cultural Representation through Cross-Cultural Performance

Chair/Moderator: **WILLIAM FELTZ**

WILLIAM FELTZ, Manager, Arts Program, East-West Center, USA, and **ERIC CHANG**, Program Assistant, Arts Program, East-West Center, USA

“Fostering Understanding Through The EWC Arts Program”

MING YANG, Degree Fellow, East-West Center, USA

“Jingju (Beijing Opera) at the University of Hawai'i”

Moonlight Hall
(1st floor)

Different Roads to Governance Reform in Asia

Chair/Moderator: **SHABBIR CHEEMA**, Senior Fellow, East-West Center and Director, Asia-Pacific Governance and Democracy Initiative, USA and **JAY HEFFRON**, Associate Director, Pacific Basin Research Center, Soka University of America, USA

SHABBIR CHEEMA, Senior Fellow, East-West Center and Director, Asia-Pacific Governance and Democracy Initiative, USA

“Pakistan: Civil-Military Relations in a Post Crisis State”

DANIEL R. FUNG, SBS, SC, QC, JP, Des Voeux Chambers, HONG KONG

“China: Emerging Issues in Corporate Governance”

WILMAR SALIM, Assistant Professor, Bandung Institute of Technology, INDONESIA

“Decentralization in Indonesia: Lessons Learned from the 'Big Bang' Approach”

WYLMA SAMARANAYAKE-ROBINSON, Faculty, University of Phoenix, USA

“Myanmar's Leadership: A Not So Odd Couple”

PUSHPA THAMBIPILLAI, Visiting Senior Research Fellow, Institute of Southeast Asian Studies, SINGAPORE

“Malaysia: Governance in a Plural Society”

7:00 pm

Welcome Reception and Cultural Presentation

Yingjie Exchange Center, Sunlight Hall (1st floor)

Hosted by the EWC/EWCA and the University of Hawai'i

DETAILED CONFERENCE SCHEDULE

continued

SUNDAY, SEPTEMBER 2

8:00 – 11:00 am **Registration Check-in and Information Desk**
open | Yingjie Exchange Center (1st floor lobby area)

8:00 – 11:00 am **Computer Room** open | Room 102 (1st floor)

8:00 – 11:00 am **Secretariat Room** open | Room 6 (2nd floor)

8:00 – 11:00 am **Hospitality Room** open | Room 7 (2nd floor)

9:00 am **Announcements**

9:00 – 10:30 am **Plenary Panel**

Priorities in US-Asia Policy

Sunlight Hall (1st floor)

Moderator: **MICHAEL ANDERSON**, US Foreign Service Officer (ret.)

AMBASSADOR JAMES MORIARTY, Former US Ambassador to Nepal and Bangladesh

SATU LIMAYE, Director, EWC in Washington

RALPH COSSA, President, Pacific Forum

Commentator:

PROFESSOR JIN CANRONG, Associate Dean, School of International Studies, Renmin University

SAROSH BANA, Executive Editor, Business India Publications

For the past year, discussion of US policy in Asia has centered on the “pivot toward Asia” or the United State’s “rebalancing” toward Asia. This panel will focus on US policy toward Asia from several perspectives including in the context of the upcoming US presidential election. Commentators from South Asia and China will provide feedback and constructive thoughts about US-Asia policy and the panelists’ presentation.

10:30 – 11:00 am **Coffee Break and Poster Session**
(1st floor lobby area)

11 am – 12:30 pm **Concurrent Panel Sessions**

Room 1
(2nd floor) **Glimpses of Women in Asia: Interdisciplinary Perspectives**

Chair/Moderator: **LINDA LINDSEY**

DONA CADY, Associate Dean of Humanities and Asian Studies, Middlesex Community College, USA

“Half the Sky: Untangling Roots to Reach the Heights of Wisdom”

LINDA LINDSEY, Senior Lecturer, American Culture Studies, Washington University in St. Louis, USA

“The Paradox of Gender Equity and Globalization in China”

JESSICA SHEETZ-NGUYEN, Associate Professor of History, University of Central Oklahoma, USA

“‘Half the Sky’: Women in China from the Qin Dynasty to the Present”

ARFA ZEHRA, Professor, Forman Christian College, PAKISTAN

“Laws but No Laws: Gender Equity in Pakistan”

Room 2
(2nd floor)

Higher Education: It is Never Quite What it Seems to be!

Chair/Moderator: **JOHN HAWKINS**

JOHN HAWKINS, Senior Consultant, East-West Center, USA

KA HO MOK, Associate VP, External Relations and Dean of Faculty of Arts and Sciences, The Hong Kong Institute of Education, HONG KONG

GLENN SHIVE, Executive Director, Hong Kong America Center, HONG KONG

“Liberal Education in Asian Universities”

JUNG-CHEOL SHIN, Associate Professor, Seoul National University, REPUBLIC OF KOREA

NANZHAO ZHOU, President, International Center of Teacher Education and Professor, East China Normal University, MAINLAND CHINA

Room 3
(2nd floor)

Technology in 21st Century Education

Chair/Moderator: **JOSEPH PETERS**

YOSHIKAZU MURAKAMI, Lecturer, Ehime University, JAPAN

“Using Web-Based Systems to Redesign Teaching and Learning in Higher Education”

JOSEPH PETERS, Dean, Education Division, Chaminade University, USA and **DARLENE PETERS**, Instructor, Chaminade University, USA

“Blending Content Instruction with 21st Century Skills: An Online Social Media Approach”

SIEGFRIED RAMLER, Senior Adjunct Fellow, East-West Center, USA

“The 21st Century Learner”

Room 4
(2nd floor)

Asia-Pacific Multilateralism: The Persistence of Older Issues in New Frameworks

Chair/Moderator: **PUSHPA THAMBIPILLAI**, Research Fellow, Institute of Southeast Asian Studies, SINGAPORE

GAYE CHRISTOFFERSEN, Visiting Associate Professor, Johns Hopkins University, USA

“The Influence of Theoretical Approaches on the Design of Crisis Management Mechanisms”

KIMIE HARA, Professor, Renison Research Professor, University of Waterloo, CANADA

“Arctic ‘Thaw’ and the Cold War Frontiers in East Asia in the 21st Century”

TAMARA TROYAKOVA, Associate Professor, Far Eastern Federal University, RUSSIA

“Russia and China: Regional Aspects of Cooperation”

DETAILED CONFERENCE SCHEDULE

Sunday, September 2 continued

Room 8
(2nd floor) **Workshop**
**Community Building with Four Treasures:
Chinese Ink, Brush, Xuan Paper,
and Stone**

Presentation by:

BARBARA BORNET STUMPH, Teacher, USA

Come enjoy our discussion of Chinese ink painting; we will have a demonstration. You can try to paint if you wish. You are welcome to attend our presentation on "Community Building" on the Internet among Chinese brush painters (CBP). We represent an Internet Forum on CBP of international artists who study ink painting with Chinese teachers abroad. Painting is deeply embedded in Chinese language and culture, as well as rooted in tradition. Chinese brush painting continues to be worthy of serious intellectual exploration; we thank all of our Chinese teachers who honor the creative process as we not only emulate past masters but also explore innovative artistic solutions.

VIP Room
(1st floor) **The Universal Language of Sports:
Community Building
in the Asia Pacific Region**

Chair/Moderator: **GARY YOSHIDA**

MARCUS KAM, Director, T3 International Limited, MAINLAND CHINA

CURT HAMAKAWA, Associate Professor of Sport Management, Western New England University, USA

GARY YOSHIDA, Foundation Development Officer, East-West Center, USA

The panel will examine the role of sports in building international understanding. It will analyze how bringing people together through events such as the 2008 Beijing Olympics and other major sports activities in Asia Pacific countries has influenced public opinion. The session will include discussion on how the sports that we play can bring people together across the divisions of region, race, and religion.

Moonlight Hall
(1st floor) **Regional Cooperation and
Conflict Reduction in East Asia**

Chair/Moderator: **RICHARD TEH-KAI CHEN**, USA

ANNIKA CULVER, Asst. Professor of Asian History, University of North Carolina, USA

"US-Japan 'Soft Power' Relations and a Rising China: the US-Japan Network for the Future Program and Japan's Pop-Culture 'Offensive'"

SU YOUN KIM, Officer, ASEAN-Korea Centre, REPUBLIC OF KOREA

"Towards Better Cultural Understanding between ASEAN and Korea"

KIYOSHI NAKACHI, Meio University, JAPAN

"The Role of Okinawa for Constructing the Best Relations between China and Japan"

TRACY STEELE, Associate Professor, Sam Houston State University, USA

"Reducing Conflict and Enhancing Cooperation: Improving Cross-Strait Relations with Taiwan by Promoting Tourism Particularly Chinese Culture and History"

12:30 – 1:30 pm **Lunch at Nongyuan Restaurant**
on Peking University (PKU) campus, location #2 on the PKU map. You will need your lunch ticket (included behind your name badge) to get your lunch.

1:30 – 6:30 pm **Half-Day Tour to either
The Great Wall or The Forbidden City**
(included in registration fee).
Please bring your half-day tour ticket with you.
Meet at the entrance of the Yingjie Exchange Center (conference venue).

6:30 pm Return to PKU
Open Evening

MONDAY, SEPTEMBER 3

8:00 – 11:00 am **Registration Check-in and Information Desk**
open | Yingjie Exchange Center (1st floor lobby area)
(11 am – 3:30 pm in Secretariat Room, Room 6, 2nd floor)

8 am – 3:30 pm **Computer Room** open | Room 102 (1st floor)

8 am – 3:30 pm **Secretariat Room** open | Room 6 (2nd floor)

8 am – 3:30 pm **Hospitality Room** open | Room 7 (2nd floor)

9:00 am **Announcements**

9:00 – 10:30 am **Plenary Panel**

**Women in Asia Pacific
Community Building**
Sunlight Hall (1st floor)

Moderator: **NANCY LEWIS**, Director of Research, East-West Center, USA

AMY AGBAYANI, Director, Student Equity, Excellence and Diversity, University of Hawai'i, USA

IRID AGOES, Chair of the American Studies Graduate Program, University of Indonesia and Chair of the Asia Pacific Development Foundation, INDONESIA

ARFA ZEHRA, Professor, Forman, Christian College, PAKISTAN

LIU CONG, Deputy Controller, CCTV News, MAINLAND CHINA (invited)

Women in many parts of the Asia Pacific have made significant strides. In East Asia and the Pacific they have the highest average labor force participation (70%) and have made the most progress in the areas of health and education, with the enrollment of girls having caught up with that of boys in many countries. Despite considerable progress, gender disparities persist in political participation and access to economic opportunity. Women's empowerment is a key theme for international development agencies and the US State Department. Closing these gender gaps is critical to achieving equitable development. Based on their own professional achievements, the panelists will reflect on women and development in the Asia Pacific region.

10:30 – 11:00 am **Coffee Break and Poster Session**
(1st floor lobby area)

DETAILED CONFERENCE SCHEDULE

Sunday, September 2 continued

11 am – 12:30 pm *Concurrent Panel Sessions*

Room 1
(2nd floor)

Reforming Cambodian Education through El Sistema

Chair/Moderator: **JAE HYUN LEE**

JI YOUNG JANG, Student, Phillips Exeter Academy, USA

HONG GU LEE, Student, University of Chicago, USA

JAE HYUN LEE, Director, Prime Education Consulting, USA

WONSEOK LEE, Student, Governor's Academy, USA

LEWIS SEAGULL, Adjunct Professor, Kean University, USA

JI HEE YOON, Student, Loomis Chaffee School, USA

Motivating Cambodian students to attend school will be achieved by introducing "El Sistema," the Venezuelan-style student orchestra. Mastering a musical instrument and playing in an orchestra fosters teamwork, a belief in something larger than oneself, and a sense of pride and accomplishment. Children actually look forward to attending school. Surprisingly, musical training also correlates with higher achievement in math and science. A student orchestra creates better educated and more constructively motivated citizens.

Room 2
(2nd floor)

Innovation in Higher Education

Chair/Moderator: **KEIKO YAMAZATO**

SEIKO KINJO, Teacher, Ishida Junior High School, JAPAN and **KEIKO YAMAZATO**, Professor, Okinawa Christian University, JAPAN

"A Comparative Study of Language Policy between Korea and Japan"

MINHO YEOM, Professor, Chonnam National University, REPUBLIC OF KOREA, **HYEON JEONG KIM**, REPUBLIC OF KOREA, and **NARAE JEONG**, REPUBLIC OF KOREA

"The Effects of Higher Education Curriculum Reform in Korea: A Case of Writing Intensive Courses"



PHOTO: ANTONIS SHEN



Room 3
(2nd floor)

People to People Relation and Information Technology

Chair/Moderator: **JUSUF SUTANTO**, Lecturer, University of Pancasila, Faculty of Psychology and Associate Researcher, University of Indonesia, Psychology Research Center, INDONESIA

IRID AGOES, Chair of the American Studies Graduate Program, University of Indonesia and Chair of the Asia Pacific Development Foundation, INDONESIA

AZYUMARDI AZRA, Director, Graduate School, Syarif Hidayatullah State Islamic University, INDONESIA

JOHN TITALEY, Rector, Satya Wacana Christian University, INDONESIA

SURYADARMA, Lecturer, Hindu University, INDONESIA

EDIE TOET HENDRATNO, Rector, University of Pancasila, INDONESIA

YUDI LATIF, Center for Pancasila Studies, University of Pancasila, INDONESIA

NYANA SURYANDI, Buddhayana, INDONESIA

KOMARUDDIN HIDAYAT, Rector, Syarif Hidayatullah State Islamic University, INDONESIA

PAULUS WIRYONO P SJ, Rector, Sanata Dharma University, INDONESIA

Room 4
(2nd floor)

Justice and Rule of Law

Moderator: **RICHARD TURBIN**

LING PING, Associate Professor, Peking University Law School and Vice President, People's Court of Funhill District (invited)

ALLISON MOORE or **JEN LEUNG**, American Bar Association Rule of Law Initiative

KAREN KNUDSEN, Director, External Affairs Office, East-West Center

RICHARD TURBIN, Founder and Senior Partner, Turbin Chu, Attorneys at Law and Vice Chairman, EWC Board of Governors

DETAILED CONFERENCE SCHEDULE

Monday, September 3 continued

Room 8 (2nd floor) **Nature Conservation in China: Balancing Protection and Development**

Chair/Moderator: **CAROL FOX**, Director for Special Projects, East-West Center, USA and **MERIL FUJIKI**, Seminars Development Coordinator, East-West Center, USA

Panelists: **China State Forestry Administration**; **The Nature Conservancy-China**; and other conservation leaders

There are more than 2,500 nature reserves in China, covering 16.6 percent of the country's total land area — home to 85% of China's wildlife population, as well as thousands of rare plants and medicinal herbs. Some of the world's most biologically diverse ecosystems are in Yunnan Province, where The Nature Conservancy has been working with local, provincial and national agencies for the past 16 years to develop a model that balances effective conservation with much-needed economic development — a challenge faced by conservationists around the world. To strengthen leadership capacity for effective protected area management, nature reserve managers from Yunnan and other provinces in China have been participating in the China Protected Areas Leadership Alliance Project, a learning partnership between the China State Forestry Administration, TNC-China and the East-West Center. Since 2008, this project has brought together more than 350 Chinese and US protected area experts and government officials to share successful conservation management strategies, practices, tools and techniques.

VIP Room (1st floor) **Addressing Diversity, Vulnerability and Social Justice**

Chair/Moderator: **CAITLIN WYNDHAM**, AUSTRALIA
PAULINE ANGELA BAUTISTA, Corporate Secretary, Bagong Lumad Artists Foundation Inc., PHILIPPINES
"Evolving a Culture of Social Justice in the Philippines"
KAM CHUEN CHOI, Part-time Lecturer, Baptist University, HONG KONG
"Activist Documentary (Social Action Documentary) for a Just Society — New Concepts in Documentary"
COSMIN CORENDEA, Associate Academic Officer, United Nations University, USA
"International Hybrid Law — Adaptive Legal Strategies to Social Vulnerability and Climate Adaptation"
JAY HENDERSON, USA
"Peeking Past Peking: Life in China's Minority Areas"
CAITLIN WYNDHAM, AUSTRALIA
"Civil Society Impact on Policy — a Social Movement in Vietnam"

Moonlight Hall (1st floor) **Five Teachings in China: Significant Local Knowledge for the 21st Century**

Moderator: **TU WEIMING**, Professor of Philosophy and founding Dean of the Institute for Advanced Humanistic Studies, Peking University

This panel will explore the meaning and relevance of Daoism, Buddhism, Christianity, Judaism, and Islam in Chinese culture. The panel will comprise leading scholars and philosophers who will engage each other as well as the audience on the various aspects of religion, culture and philosophy.

12:30 – 1:30 pm **Lunch at Nongyuan Restaurant**
on Peking University (PKU) campus, location #2 on the PKU map. You will need your lunch ticket (included behind your name badge) to get your lunch.

1:30 – 3:00 pm **Plenary Panel
The Changing East-West Center**
Sunlight Hall (1st floor)
Moderator: **CHARLES E. MORRISON**
East-West Center Directors:
TERANCE BIGALKE, Education Program
KAREN KNUDSEN, Office of External Affairs
NANCY LEWIS, Research Program
SATU LIMAYE, East-West Center in Washington

3:00 – 3:30 pm **Coffee Break** (1st floor lobby area)

3:30 – 4:30 pm **EWCA Alumni Membership Meeting**
Open to all conference participants
Yingjie Exchange Center, Sunlight Hall (1st floor)

5:30 pm Buses leave for Aloha Banquet at the Four Points by Sheraton Beijing (Tower 1, No. 25 Yuandan Road, Haidian District). Meet at the entrance of the Yingjie Exchange Center (conference venue).

6:30 – 9:00 pm **Farewell/Aloha Banquet
including Alumni Talent Show**
Four Points by Sheraton Beijing

9:30 pm Buses leave to go back to PKU



PHOTO: WOSHING AU

EWC Distinguished Alumni Awards

This award honors former East-West Center participants for exceptional accomplishments in their professions and contributions to East-West relations and understanding. The award was established by an endowment fund donated by the late Dr. Dai-Ho Chun, former director of the Center's Institute of Technical Interchange.

Two outstanding alumni will receive the 2012 EWCA Distinguished Alumni Award:



Senen Bacani, Former Philippines Secretary of Agriculture under President Corazon Aquino, is currently the Chairman and President of the agri-business La Frutera, Inc., one of the top banana exporters in the Philippines. Previously, Bacani, who pursued an MBA from the University of Hawai'i

while he was at the East-West Center from 1966-1968, had spent 20 years in a successful career with Dole Food Company, including serving as Dole's country manager in Costa Rica and the Philippines. After leaving Aquino's administration, he spearheaded the establishment of the first large-scale banana plantation in the autonomous region of Muslim Mindanao, helping to bring jobs and stability to the war-torn region in his belief that "peace and development go together." Employing more than 1,800 people, roughly 90 percent of whom are Muslims and 10 percent are Christians, Bacani and his business partners envisioned La Frutera as a model of how Christians and Muslims can work together. In 2006 he was named Entrepreneur of the Year by SGV Ernst & Young.



Amanda Ellis, who pursued a PhD in Political Science while she was at EWC from 1986-1989, is currently New Zealand's Deputy Secretary of Foreign Affairs and Trade in charge of international development. Before returning to the ministry, where she had earlier been in the Foreign Service at postings in

Paris, the Pacific and Asia, Ellis worked as the Lead Specialist for Gender and Development for the World Bank, where she played a vital role in economically empowering women in an impressive number of the world's developing countries. "It's fascinating how things I was involved with at the Center in my early career, how these connections have been maintained and strengthened to become a theme in my professional life," remarked Ellis.

East-West Center Association Presidential Recognition Award



The newly established East-West Center Association Presidential Recognition Award will be given by outgoing EWCA President Ricardo Trimillos to tireless volunteer (and 1962-64 alumna) **Itsuko Suzuki**. Itsuko established the Association's Mentoring Program 10 years ago and has been the key force behind the

program's success. In addition to her leadership of the Mentoring Program, which has involved hundreds of EWC students and professionals from the Honolulu community, she has served on the EWCA-Hawai'i Chapter Board for many years. Her dedication and commitment to the EWC is an inspiration to other

alumni volunteers. Selected as one of two grantees out of 2,000 applicants from Japan, Itsuko, going against cultural norms for Japanese women at that time, came to the Center in 1962 from Tokyo as a graduate student in Social Work, a field not offered at the graduate level in Japan in the '60s. After receiving her degree, she worked for the Japanese Red Cross and the International Social Service in Tokyo and eventually returned to Hawai'i and served for 30 years as a medical social worker and diagnostic clinic coordinator for the Hawai'i State Department of Health. Recognizing how fortunate she was to receive the EWC Scholarship and how it shaped the course of her life, she felt moved to give back to the East-West Center community and share the benefits she has received with the next generation of students.

EWCA Outstanding Volunteer Awards

This award recognizes outstanding alumni volunteers who have provided significant contributions to the programs and activities of the East-West Center Association. Three individuals will receive the 2012 EWCA Outstanding Volunteer Award:



Lyn Flanigan co-chaired the EWC/EWCA 50th Anniversary Conference in 2010 and served as President of the EWCA Executive Board from 2009-2012 and as a Board member from 2004-2010. She came to the East-West Center from Indiana as an Asian Studies major in the 1960s (Institute for Student Interchange 1965-1968).

After obtaining her master's degree, Lyn lived in Asia for several years and then returned to the Center where she worked as a program officer for 12 years. During this time, which she calls her "most memorable period at the Center," she and her family hosted many EWC students in their home. While working, she obtained her law degree at the University of Hawai'i and then worked as an attorney in Honolulu. She was appointed to the EWC Board of Governors in 1992 during a time of transition. During her nine years on the Board she focused on reinvigorating alumni relations. Professionally, Flanigan recently served for eight years as executive director of the 7,000-member Hawai'i State Bar Association.



Larry Foster, an EWC alumnus from 1978-1981 in the Culture Learning Program, has given back to the East-West Center community in many ways over the years having served as President of the East-West Center Alumni Association Executive Board from 2005-2009, as an Ex-Officio member

of East-West Center Board of Governors, and as member on the Planning Committees for the International Conferences held in Vietnam (2006) and Bali (2008). Professionally, he served as Dean of the University of Hawai'i at Mānoa's William S. Richardson School of Law from 1995-2003. Before obtaining his legal education at the U.H. Law School as an East-West Center grantee, Larry received a PhD in Chinese Studies and taught Chinese language at the University of Hawai'i and the University of Washington. He has been active in law reform issues in Japan, China and the Pacific and serves as a Legal Advisor to the American Chamber of Commerce in Shanghai and as an elected member of the Governing Council of the Inter-Pacific Bar Association.



Nasti Reksodiputro, Communications liaison for the EWCA-Jakarta Chapter, was one of the co-chairs of the organizing committee for the EWC/EWCA International Conference in Bali in 2008. An EWC grantee in the early 1960s (Institute for Student Interchange 1962-64), she returned to Indonesia with a degree in Teaching English as a Second

Language. During her years at the Center, she experienced the sharing, support and cooperation among the students from very diverse countries and decided to utilize those elements to create a library on wheels for children. She founded Yayasan Pustaka Kelana (the Wandering Books Foundation), dedicated to increasing children's access to books, fostering literacy, and spreading the joy of reading in her country. After retiring from the University of Indonesia, Reksodiputro managed to collect some 3,000 books. The bookmobile took to the streets of Jakarta in 1996. Now, Pustaka Kelana has three bookmobiles and a stationery reading room in East Jakarta. With increasing support, the library continues to expand and branch out. Thousands of children across the city regularly use the foundation's libraries. The bookmobiles visit schools and neighborhoods, targeting children in the middle- to lower-income bracket. Reksodiputro is also an active member of a Jakarta-based foundation for dyslexic children.

EWCA Outstanding Chapter Awards

This award recognizes outstanding EWCA Chapters which have provided significant contributions to the goals and programs of EWCA and support of the mission of the East-West Center. The 2012 EWCA Outstanding Chapter Awards will be given to EWCA alumni chapters in:

Okinawa, Japan – The Okinawa chapter has demonstrated ongoing strong support to the students of the EWC through the chapter's EWCA Okinawa Alumni Scholarship Foundation. The chapter also recently published a book of EWC alumni essays titled *Bridge of Rainbows Linking East & West* to commemorate the East-West Center's 50th anniversary.

Brisbane, Australia – The Brisbane chapter engaged in extensive community outreach activities including volunteer work with the Australian Red Cross in support of relief and recovery efforts for the people affected by the devastating floods in Queensland. The chapter has also collaborated with the EWC alumni chapter in Nepal by financially supporting the educational goals of two economically disadvantaged Nepalese students.

Members of Conference Committee

East-West Center
Charles E. Morrison
Karen Knudsen

**East-West Center
Association**
Nirendra Maske
Ric Trimillos
Zhongming Pan

Conference Co-Chairs
Ric Trimillos
Gordon Ring

**East-West Center
Alumni Office**
Noreen Tanouye
Trina Chang

Alumni Volunteers
Itsuko Suzuki
Paul Meyers

Student Assistants
Jason Li
Rashae Rabang-Corpus

Conference Sub-committee Members

Overall
Karen Knudsen
Noreen Tanouye

Conference Program
Co-Chairs:
Terance Bigalke
and V. Bruce Tolentino
Ric Trimillos
Loretta Pang
Diane Peters-Nguyen
Sharon Lucien
Noreen Tanouye

Conference Registration
Trina Chang
Pat Matsunaga

Development
Mangmang Brown
Gary Yoshida

Logistics
Carolyn Eguchi
Qinghong Wang

Program Booklet
Noreen Tanouye
Gordon Ring
Kennedy & Preiss Design

Public and Media Relations
Derek Ferrar

Advisers
Qinghong Wang
Betty Buck

EWCA Beijing Chapter
Zhongming Pan
Haiming Wen
Sherie Cui
Xiaorong Chen

**In cooperation with
Peking University staff:**
Zhenya Chen
Ying Wang
Yuanyuan Du (Clara)
Yulan Song
Xinguo Liu

EWCA Executive Board

Sarosh Bana
Jenny Miller Garmendia
Eric Hanson
Carl Hefner
Solomon Kantha
Gordon (Kem) Lowry, Jr.
Nirendra Maske

Vijayan Munusamy
Steve Olive
Edward (Ned) Shultz
Estrella Besinga Sybinsky
Tina S. Takashy
V. Bruce Tolentino
Arfa Zehra

EWCA Chapter Leaders

Rajesh Kumar Aggarwal
Shyam Agrawal
Ekramul Ahsan
Bill Armbruster
Sarosh Bana
Sovath Bong
Naris Chaiyasoot
Iraphne Childs
Ramon Clarete
Carlos Peloi dos Reis
Pamela Drymiller
Arjumand Faisal
G.B.A. Fernando
Seiko Furuhashi
Mohamad Saleh Ghazali
Craig Gima
Carl Hefner
Hoe Hoang
Yasuo Hoshino
Muhammad Ibrahim
Jonathan Jacobs
Tomi Johnston
Purnawan Junadi
Solomon Kantha
Yu-Jen Kao
Susan Kreifels
Claire Langham
Jeong Taik Lee
Thein Lwin
Kazi Suleman Memon
Anak Agung Muninjaya
Ari Pahlawi
Zhongming Pan
Sonna Belliappa Pemanda
Laura Ramos
Nageswara Rao
Chanthavong Saignasith
Seok-Hoon Seng
Shankar Sharma
Jessica A. Sheetz-Nguyen
Glenn Shive
Kamal Siddiqi
Barbara Stumph
Shigeo Tonoike
Anny Wong
Caitlin Wyndham
Keiko Yamazato
Arfa Syed Zehra

Chandigarh
New Delhi
Dhaka
New York
Mumbai
Phnom Penh
Bangkok
Brisbane
Manila
Dili
Chicago
Islamabad
Colombo
Kansai
Kuala Lumpur
Media Chapter, co-chapter leader
Hawai'i
Hanoi
Nagoya
Faisalabad
Ontario
Arizona
Jakarta
Port Moresby
Taipei
Media Chapter, co-chapter leader
Southern California
Seoul
Yangon
Hyderabad
Bali
Aceh
Beijing
Chennai
Sydney
Hyderabad
Vientiane
Singapore
Kathmandu
Asian Studies Development Program
Hong Kong
Karachi
Northern California
Tokyo
Washington, D.C.
Asia Pacific Leadership Program
Okinawa
Lahore

Conference Sponsors

Our sincere thanks to the businesses and organizations who helped make this conference possible through their generous donations.

Mahalo!

Gold Sponsor



Sinomedia Int'l Group Inc.

Supporting Sponsors

Four Seasons Holiday, Co.

Roberta's Gift Basket and Flowers: Roberta Takamoto

Sheraton Waikiki Hotel & Resorts

Tour into Tibet

Trade West, Inc.

University of Hawai'i at Mānoa

University of Hawai'i Alumni Association

World Destinations, Inc.

DISCOVER CHINA ANYWHERE

Our mission is to be North America's comprehensive source on all things China by using a variety of platforms and digital spaces. Moreover, we provide a wide variety of services – we publish and distribute books and offer lectures and training programs. Sinomedia comprises the publishing imprints of China Books and Long River Press.



LONG RIVER



SINOMEDIA INTERNATIONAL GROUP

360 Swift Avenue Suite 48, South San Francisco, CA 94080

China Books | Long River Press | www.webonchina.com

East-West Center Association (EWCA) Alumni Scholarship Fund

The East-West Center Association (EWCA) began awarding Alumni Scholarships in 2002 to make East-West Center's transformational educational programs accessible to all qualified students, regardless of their economic resources. Scholarships are awarded to graduate degree students based on academic excellence, financial need, leadership potential, and a strong commitment to community service and involvement with EWCA. These stand-alone scholarships have helped to increase the number of EWC students, and provide supplemental funding to graduate degree fellows who need additional support for travel to the Center and for other personal expenses beyond the graduate degree fellowship.

EWCA Alumni Scholarships are created from three sources of funds:

- Contributions to the EWC Foundation's annual campaign,
- Investment income from the Alumni Endowment Fund, and
- Proceeds from the Silent Auction and International Bazaar at the annual EWC dinner.

ALUMNI ANNUAL SCHOLARSHIP FUND

All alumni and friends of the EWC are welcome to designate their gifts donated during the annual campaign to the Alumni Annual Scholarship Fund. Because this is not an endowment, gifts to the fund are available for immediate use.

ALUMNI ENDOWMENT FUND

EWCA alumni created the Alumni Endowment Fund as a legacy to help future generations of students share the EWC experience. Contributions can be made in the form of cash, bequest/trust, appreciated securities, or life insurance. This fund includes all gifts from alumni who designate their donations to the endowment. Funds are placed in the EWC Foundation's Endowment Fund, and held in perpetuity. Income from the investment of these funds is used to fund scholarships.



INVESTING IN THE FUTURE: SCHOLARSHIPS CHANGE LIVES

Your gift makes a real difference in the lives of East-West Center students to prepare them for leadership in the Asia Pacific region. This year's EWCA Alumni Scholar Award recipients are Zaya Dondov (Mongolia), Vinogiri Krishnan (Malaysia), Barnabas Cordell Seyler (USA), Jeny Shrestha (Nepal) and Phoumy Sok (Cambodia).

Thanks to the generosity of alumni and community donors, the EWC Association Alumni Scholarship Fund has been able to distribute over \$236,000 so that 83 students from 19 countries could participate in EWC education programs.

Please make your gift today by mailing your gift or using our secure website at EastWestCenter.org/donatenow. You can designate your donation to the Annual Fund for Student Scholarships or Alumni Endowment Fund for Student Scholarships.

You can also have your financial institution transfer (quarterly) payments directly from your checking account to EWC (US bank accounts only). Sign up by contacting the EWC Foundation at 808.944.7143 or by email Foundation@EastWestCenter.org to request the authorization form or going to the EWC Foundation website EastWestCenter.org/support-the-ewc.

A gift of any size directly supports East-West Center students and programs.

HONOR ROLL OF DONORS

On behalf of the East-West Center, we would like to thank our donors who have generously contributed to the East-West Center Association (EWCA) Alumni Annual Scholarship Fund and Alumni Endowment Fund for Student Scholarships from inception to July 2012.

Anonymous (20)
 Szarina Abdullah
 Shigeyuki Abe
 Joseph A. Abel
 Masayuki Adachi
 Paul W. Adams
 Roberta E. Adams
 Linda Adamson
 Dr. Ronny Adhikarya
 Amy Agbayani
 Saleem Ahmed
 Takamasa & Suzanne
 Akiyama
 Susan L. Allen, PhD
 Bruce M. Allender
 Jose B. C. & Patricia Alvarez
 Ann M. Ambiel
 Roger T. Ames
 Fred & Kiyoko Anderson
 Marilyn J. Anderson
 Michael H. Anderson
 Beng Choo Ang
 Ryuji Arai
 William R. Armbruster
 Richard R. Arnold
 Tomohide Ashida
 Association of Maternal &
 Child Health Programs
 Colonel Ronald H. Averill,
 US Army (Retired)
 Gale Awaya McCallum
 AXA Foundation
 Fusako & Masao Baba
 Senen & Yolanda Bacani
 Adolph F. Bakun
 Richard E. Ball, PhD
 Dennis E. Barton
 Professor Libby Bay
 Fay E. Beauchamp
 Carl B. Becker
 Dr. Yukiko N. Bedford
 James M. Bedore
 Harumi Befu
 Bella Z. Bell
 Daphne & Mike Bell
 Susan Sutterfield Bells
 Benji Bennington
 Daniel & Elizabeth Berman
 Teresita G. Bernales
 John Beruldsen
 Ardith Miller Betts
 Dr. Verner C. Bickley
 & Mrs. Gillian Bickley
 Terance & Jan Bigalke
 Walter A. Billingsley
 Mary I. Bockover
 William Bodde
 Howard Philip Bodner
 Barbara A. Bonner
 Marion R. Boultsbee
 Ann M. Bouslog
 Ari & Dolly Brara
 Dr. Jaswinder Brara
 Barbara Brewer
 Dr. Frances M. Brookey
 Elizabeth Buck
 John M. Bullard
 Joyce A. Bullen
 Chalintorn & Fred Burian
 Mable C. Burks
 Larry L. Burmeister
 Susan H. Bush
 Joan Cabreza
 Bernardino G. Cagauan Jr.
 Bill Callahan
 Patrick T. Callan
 Mr. & Mrs. Lionel E. Camara
 Ms. Susan M. Campbell
 Jill Canfield
 Sharon A. Carstens
 Charlotte Cascio
 James Jim Castle
 Helen E. Cedeno
 Marina J. Chabot
 Ekachai Chairasertsithi
 Willie C. Chan
 Chiao-Sen Chang
 Crescencia V. Chan-Gonzaga,
 PhD
 Boonthai & Saichay Chantavy
 Eddie & Sheila Chao
 Neel K. Chapagain
 Karen Hubenthal Chappell
 Wallace Chappell
 Dr. & Mrs. Donald F.B. Char
 G. Shabbir & Sharon Cheema
 Chao-Nan Chen
 Shu-dong Chen
 Charles S. Johnston
 & Xin Chen
 Zhenping Chen
 Paul M. F. Cheng
 China Discovery Tours
 Minja & Yong-Ho Choe
 Alan G. & Joan M. Choi
 Jong Kun Choi
 Uhn-Kyung Choi
 Gaye Christoffersen
 Christopher, Smith
 & Associates LLC
 Kwong Y. Chuang
 & Cheng T. Lim
 Rina C. Y. Chung
 Ma Mirella Gotangco-Clarete
 Danny & Lourdes P. Clark
 Paul Clark
 Prof. Ansley J. Coale
 Douglas A. Codiga
 Prof. John J. Cogan
 Janey Cole
 Stuart H. Coleman
 Nancy M. Conradt
 Dr. Carolyn D. Cook
 John & Catharine Cool
 Jack Corman
 William Glenn Court
 Elsie Cunningham
 Pamela DaGrossa
 & Leslie Poland
 Fitha W. Dahana
 Larry Daks
 Richard Damrow
 Marivic G. Dar
 Tom Davenport
 Daw Pwa Yin
 William Theodore deBary
 Jay & Marti deBenedetti
 Cota Deles-Yabut
 Bruce Delman, PhD
 Kazuko & Akira Demura
 Mr. Hitoki Den
 Donna Dequina
 Cheong H. Diong
 Achmad & Mendl W. Djunaidy
 My Do
 Hiroko H. Dodge
 Masao Doi
 Susan Anne Dolan
 Ray T. Donahue
 Ernie Donehower
 Dr. Rick Donohoe
 Doris Duke Management
 Foundation
 Minna Doskow
 Ms. Jo Ann W. Dotson
 Vilath Douangphoumy
 Pamela Pallissard Drymiller
 Nader C. Dutta
 Makoto Ebihara
 Yvonne Han Edelin
 Jeanne L. Edman
 Khaleda Ekram
 Lucien Ellington
 Amanda Ellis & Keric Chin
 Robert Eng
 Lawrence M. G. Enomoto
 Modesta B. Enriquez
 Roger Ernst
 Glenna Eshleman
 Phil & Jaynie Estermann
 Zenaida Estrada
 EWC Association
 EWCA Australia Chapter
 EWCA Chennai Chapter, India
 EWCA Chicago Chapter
 EWCA Korea Chapter
 EWCA Okinawa Chapter
 EWCA Tokyo Chapter
 EWCA Yangon Chapter
 Carol C. Fan
 Julien Farland
 John W. Farrington
 David W. Faust
 William Feltz
 Candace Finkelston
 Victor E. Flango
 Lyn Flanigan
 Kathy Foley
 Donna Y. Fong
 Mary C. Forestieri
 Larry & Brenda Foster
 Bob Francescone
 Karl Frogner & Kanitha
 Silthornvisudh Frogner
 Raymond-Jean Frontain
 Hiroshi Fuji
 Manabu Fujimura
 Carol F. Fujita
 Dr. Fumiko Fujita
 Carol E. Fullerton
 Mary Jo Rossi Furgal
 Seiko Furuhashi
 Rosita Gallega Galang
 Catherine Muirhead Gallagher
 Milann Gannaway & John Hoy
 Gannett Foundation
 Dely P. Gapasin
 Catherine Garay
 Reynaldo P. Garay, PhD
 Jacob A. Gayle, PhD
 Nancy J. Geiss
 Buddy & Melga T. Gendrano
 Dr. Norman Geschwind
 & Letizia R. Geschwind
 Ian A. Gill
 Barry Keith Gills
 Lisa A. Girion
 Howard Giskin
 Dr. Gloria Golec
 Donald & Laura Goo
 Ayako Graefe
 Walter A. Graham Jr.
 Sylvia Gray
 Jacquelyn W. Green
 Orian H. Greene
 Elizabeth Greenman
 Dr. & Mrs. Paul R. Gregory
 Violet E. Gren
 Dr. Conrad E. Gubera
 John & Marcia Gunnarson
 Amit Gupta
 Anupy Singla Gupta
 Robert and Adele Gurevich
 Chance I. Gusukuma
 Mayu Hagiwara
 Koichi Haji
 Linda E. Hamada
 Kiyoshi Hamano
 Elizabeth Y. Han Tseng
 Sandra & Louis Handler
 Karen T. Harada
 Takayoshi Harada
 Yutaka Harada
 Koichi Hasegawa
 Yoichi Hasegawa
 Chie Hashimoto
 Mitsuo Hashimoto
 Khalid Hashmani
 Norie Hata
 Hawaiian Electric Company
 John N. Hawkins
 Iwao Hayakawa
 Ryuji Hayashi
 Dr. & Mrs. Lawrence R. Heaney
 C. Randall Henning
 Dal M. Herring
 Robert B. Hewett
 David Hickey
 Ron Himes
 Drew E. Hinderer
 Mitsuo Hirata
 Kiyosi Hiroshima
 Diddy R. Hitchins, PhD
 Tetsuko S. Ho
 Kazuaki & Katsuko Hojo
 Lon T. Holden
 Oliver V. Holtzmann
 Keiko Honma
 Dr. James F. Hopgood
 Bhanuphol Horayangura
 Iris & David Horner
 Yasu & Bongza Hosomatsu
 Ms. Adriana M. Houk
 Debra Lynn Hughes
 Gail F. Hughes
 Ms. Karen F. Hughes

HONOR ROLL OF DONORS

continued

Terry & Valerie Hull
 Al Hulsen
 Nancy G. Hume
 Mr. & Ms. Frank Liang-Hao Hung
 Aziz Husain
 Teruhisa Ichihara
 Dr. Yoshiki Iinuma
 Kokichi Iizasa
 Peter Shigehiko Iizuka
 Cheryl Kaneko Ikemiya
 Anne E. Imamura
 May Leiko Imamura-Uruu
 Atsushi Inaba
 Narahiko Inoue
 International Association of EWC Alumni
 Robert Cirelli Irwin
 Lorraine Isaacs
 Hiroshi Ishiguro
 Yoshiko Y. Ishikawa
 Yoshiko K. Ishizawa
 Takuzo Isobe
 Osamu Iwata
 Dato' Ir Dr. A. Bakar Jaafar
 Prof. Abdul Jabbar
 Sarah Jackson-Han
 Syed Z. Jaffery
 Kathleen Jamieson
 Cecilia Osteen Jan, PhD
 Peter P. Jennings
 Dong K. Jeong
 Jhamandas Watumull Fund
 Hisatake & Akiko Jimbo
 Ryuzo Jisaka
 Dr. Charles J. Johnson & Dr. Xiaodong Wang
 Dale R. Johnson
 Dixon C. Johnson
 Edwin L. Johnson
 Mary M. & Donald (Dickens) Johnson
 Todd M. Johnson
 Dr. David Jones
 Dr. Garth N. Jones
 Royce A. Jones
 M.J. Jordan
 Hee-Nam Jung
 Jun Kabigting
 David Kaeuper
 Hiroshi & Miyoko Kakazu
 C. Kamasaki
 Yoko Kamikawa
 Suntharalechmy Kanagasabai
 Carmen G. Kanapi
 Michikazu Kaneda
 Sally Lampson Kanehe
 Junichi Kaneko
 Eung-Seon Kang
 Soon Hock Kang
 Mr. Yu-Jen Kao
 Theodore N. Kaplan
 Judith N. Kappenberg
 Ahsan Kareem
 Itsuko O. Kasai
 Mitsuo Kato
 Kosho Katsura
 Clare C. Kawada
 Lysia Kee
 Noel J. Kent, PhD
 Angela Kay Kepler
 KFG Properties, Inc.
 Dr. & Mrs. Thao Khamoui
 Dr. & Mrs. M. Asad Khan
 Peter Kilby
 Timothy Killikelly
 Byung Soo Kim - Alumni 77
 Prof. Kim, Gyung-Ran
 Heesook Kim-Yea, PhD
 Mary-Ann Filotas Kim
 Soon K. Kim
 Masashi Kimura
 Suzanne Kindervatter
 Isao Kinjo
 Jane M. Kinney
 Yuko Kitada
 Yoshikatsu Kiuchi
 Greg & Karen Knudsen
 Eiji Kobayashi
 Shigeo Kobayashi
 Victor & Cleo Kobayashi
 Stanley H. Kober
 Grace S. Kohatsu
 Ryuichi Komatsu
 Teresita Chan Kopka
 Korea Fulbright Alumni Association
 Michiko U. Kornhauser
 Tom Korson
 Christine W. Kulikowski
 Ruriko Kumano
 Teruyuki Kume, PhD
 Tetsuya Kunihiro
 Kuo, Chang-Yang
 Eddie C. Kuo
 Akemi & Misako Kurokawa
 Felix B. Kwan
 Sumner J. La Croix
 Charles S. La Monica
 John Lam
 Chhom-Reak "Therry" Thong Lambert
 Edgar Folk Lambert III
 Flora G. LaMontagne
 Kristy H. Lampe
 Stephen Lane
 Gary & Bach-Mai Larsen
 Betty Lou Larson
 M. D. Lauterbach
 Bob Leaversuch
 Fah Onn Lee
 Jeong T. Lee
 Sang-Chul Lee, PhD
 Howard Leichter
 Dr. Edna A. Leonard
 Man-Kam Leung
 PingSun Leung
 Dr. Sam Cheung Shing Leung
 Jack & Sandy Lewin
 David C. Li
 Justin B. Liang
 Ko-Lin Jody Liao
 Prof. Yuan-lin Lin
 Linda L. Lindsey
 Arthur Lisciandro
 Suzanne Brown Little
 Alicia B. Llacuna
 Timothy & Zenny Logue
 Jesse R. Long
 Domingo Los Banos Jr.
 Lena Y. Low
 Dr. & Mrs. Kem Lowry
 Shyue-Ching Lu
 Chi-Lin Luh
 K. J. Luke Foundation
 Norman Y. Luther
 James D. Lynn
 Nnenna J. Maduforo
 Federico V. Magdalena
 John H. Maier
 Sumi & Henry Makey
 Etsuko Makino
 Kanika Mak-Lavy
 Dr. Ashok K. Malhotra
 Parashar & Mohini Malla
 Malmad, David L.
 Ingeborg Kendall Inge Maranto
 Michele Marion
 Dr. Ely J. Marquez
 Betsy Volkmann Marshall & Leigh Marshall
 Gary L. Marshall
 Julie A. Marshall & Richard G. Jones
 Koichi Maruyama
 Andrew & Janet Mason
 Hazel C. Mason
 Michael & Judy Masters
 Kaoru S. Matsuda
 Hideki Matsudo
 Professor Kenichi Matsui
 Keizo Matsumura
 Hiroshi Matsuoka
 Yoko Matsuzaki
 John & Mary Mayo
 Patricia & Sam McCall
 David P. McCauley
 Laurene McClain
 Isabel S. McClendon
 McInerney Foundation
 Maxwell G. McLeod Jr.
 O. Donald Meaders
 Walter N. Meciuinas
 Sheila A. Meehan
 William N. Melton
 Kwang-Ho Meng
 Thomas H. Mesner
 Laura M. Miho
 Dr. Dragan Milivojevic
 Alan C. Miller
 Dr. Linda Karen Miller
 Sari Miller-Antonio
 Dr. Joyce Mills
 Kazuo Minato
 Touru Miura
 Kimitada Miwa
 Charlotte O. Miyamoto
 Jennie Y. Miyasaki
 Fujio Miyasato, M.D.
 Motoyasu Miyata
 Kimie Miyazaki
 Ramli Mohamed
 M. C. Mohan & Mrs. P. Mohan
 Christina Molinari
 Michael V. Molloy
 David J. Mongold
 Marie A. Monsen
 Mara Montelibano
 The J.P. Morgan Chase Foundation
 Rie Mori
 Ambassador & Mrs. James Moriarty
 Mr. Yoshihisa & Reiko Morito
 Charles E. Morrison
 Rebecca L. Morrison
 Ronald P. Morrison
 Dr. Susan R. Morrow
 Cecile L. Motus
 Lyn Y. Moy
 Gerald Mullins
 Anne Mulvaney
 Dr. Savario Mungo
 Stan & Aileen Munro
 Robert L. Munroe
 Professor Yoshikazu Murakami
 Yoshinori Murakami
 Katsuhiko Murata
 Chifumi Nagai & Michael Weitzenhoff
 Basskaran and Chor Eng Nair
 Reiko & Seiichi Nakada
 Rose Nakamura
 Edwin M. Nakasone
 Akio Nakata
 Katherine T. Nakata, PhD
 Hisashi Nakatomi
 Dr. Etsuko Nakayama
 Thomas S. Namiki
 Desai A. Narasimhalu
 Dr. & Mrs. Idabagus Narendra
 Joan M. Natalie
 Elaine Nathan
 Seiji & Jane Naya
 Sheila Nayar
 Timothy Siu-Man Ng
 Arthur Ngiraklsong
 David Nguyen
 A. Richard Nichols
 Yoshio Niho
 Kenneth Nishihara
 Shoji Nishimoto
 Yoshitaro Nishimura
 Wendy A. Nohara
 Takashi Nonin
 Ernest J. Notar, PhD
 Janice Nuckols
 Peter & Karen (Reid) Nunan
 Nobuko Miyama Ochner
 Dr. Setsuo Ogasawara
 Naohiro Ogawa
 Lauri B. Ogumoro
 In-Hwan Oh & Chung Ja Kong
 Yukio Ohta
 Tae Okada
 Yumiko Okamoto
 Kunio Okuda
 Midori Okugawa
 Ken & Yahui Olenik
 Steve & Gigi Olive
 Tory, Orit, April, Alex & Lyla Olshansky
 Raymond W. & Bonnie D. Olson
 Shoichi Ono
 Mr. Charles N. Onufer
 Sara E. Orel
 Hidefumi Oshima
 Kensei Oshiro
 Tsunehiko Oshiro
 Gerald & Tsue Ostermann
 Tamaki Osumi
 Tadahisa Ota
 Yoshiko Otsubo
 Hisao Otsuka
 Joseph L. Overton, PhD
 Rebecca Sanchez Ovitt
 Dr. William B. Owen
 Tsunao Oyama
 Dr. Elaine S. Padilla
 Bert C. Palencia, PhD
 Martha H. Palit

HONOR ROLL OF DONORS

continued

Loretta O. Q. Pang
 Michael Parke
 Dr. Sunita Peacock
 Peter & Daisy Pee
 Dave & Kathleen Pellegrin
 Thomas M. Pendergast
 Ms. Kathryn K. Peppe
 Dr. Barbara Bennett Peterson
 William S. Pfeiffer
 Teresa Phuong-Mai Phan
 Dr. Susan J. Pharr
 Sheilah A. Philip
 Mike Philson
 Diane Pierce-Williams
 Eveline Grapens Piersma
 Poh Kok Kian
 Gerald & Olive Poliks
 Elaine Margaret Pospishil
 Clyde V. Prestowitz Jr.
 Prof. Ross Prizzia
 James H. Proctor Jr.
 Dr. Rita Pullium
 Stephen Pyrczak
 Jean-Louis Rallu
 A. Terry Rambo
 & Patma Vityakon Rambo
 Siegfried Ramler
 Morita Rapoza
 C. Tait Ratcliffe
 Meherunnissa N. Rehmani
 Nasti Reksodiputro
 Dr. E. Bruce Reynolds
 Dr. Joanne Rhone
 Dr. Lawrence C. Rhyne
 Marcia R. Rickard
 Gordon & Milly Ring
 Gene A. Rister
 Carol O. Roberts
 Paul A. Rodell
 Delia B. Rodriguez-Amaya
 Peter Rose
 Joan Rubin
 Iftikhar Saeed
 Eiji Saito
 Katsuyuki Saito
 Masaaki Sakashita
 Masaro Sakashita
 Dr. Chhany B. Sak-Humphry
 Rafael & Elizabeth Salva Cruz
 Puongpun & Thanh-Lo
 Sananikone
 Marilyn P. Santos
 Setijati Sastrapradja
 Dr. & Dr. Satha-Anand
 June T. Sato
 Kanji Sato
 Mitsugi Sato
 Robert S. Saunders
 Timothy Savage
 Alvin & Trudy Schandler-Wong
 Carl Schwartz
 John H. Scranton
 Ronald G. Scronce
 Robert M. Sears
 Valerie Frances Sedlak, PhD
 Sachiko Seino
 Sachio Semmoto
 A. Seshan
 Mr. & Mrs. Gokul R. Shah
 Vicki L. Shambaugh
 Kevin R. Shaney
 Stephanie A. Shapiro
 George W. Shardlow, PhD
 Dr. Narendra P. Sharma
 Anees A. Sheikh, PhD
 Sam & Connie Shepherd
 Vittalla & Tina Shettigara
 Kazuko I. Shibahara
 Tetsuya Shibayama
 Jung Soon Shim
 Yasuko Shimizu
 Myong S. Shin
 Jo Shinsho
 Setsuko Y. Shinsho
 Kiyoshi Shioiri
 Ichiro Shirakawa
 Cindy Yoshiko Shirata
 Ghulam Shirazi
 Glenn Shive
 Craig V. Showalter
 Omkar Shrestha
 Ms. Kakuko Aoba Shuku
 Edward J. Shultz
 Toufiq & Ulrike Siddiqi
 Anahita Thanawalla Sidhwa
 Ada Perk Simmons
 Charles Simons
 Kenneth & Martha Simonsen
 Abigail Sines
 Devinder Singh
 Joginder Singh
 Kirpal Singh
 Han & Xenia Siregar
 William Slaymaker
 Ms. Phyllis J. Sloyer
 Pamela J. H. Slutz
 Kim Small
 Curtis D. Smith
 Larry E. Smith
 Dr. Daniel So
 Vincentius Soesanto
 Chunghee S. Soh, PhD
 Jung S. Son
 Wi S. Song
 Tiane L. Soulatha
 Jim Carleton Steele
 Gary D. Stice
 Frederick D. Stone
 Ms. Nan Streeter
 Kristen L. Strellec
 Paul & Proserfina Strona
 Dungywe Su
 Jeff Su
 Wen-Yu Su
 Mathinee Subhaswadikul
 Jun Sudo
 Cho Soon Suh
 A. F. Sukowatey
 Teresa A. Sullivan
 Mr. & Mrs. Dening Sun
 Russell B. Sunshine
 Yasuyuki Suto
 Mitsuaki & Itsuko Suzuki
 Kanichi Suzuki
 David A. Swanson
 Harold & Marilyn Swanson
 Joanne E. Swearingen
 Peter, Estrella & Andrea
 Sybinsky
 Elizabeth Witte Tackaberry
 Mildred Machiko Tahara
 Ambassador Raymond R.M. Tai
 Miwako Takahashi
 Satomi Takahashi
 Eimatsu Takakuwa
 Hiroaki Takasaka
 Augustina S. Takashy
 Linda Chu Takayama
 Kazuhiko Takemoto
 Akira Tanahara
 Dr. Harumi Tanaka
 Hiroshi Tanaka
 Frank Tang
 Khamtan and Chou L.
 Tanhchaleun
 Nobukazu Tanii
 Kazumasa Tatsuzawa
 Charles E. Tatum
 William M. Taylor
 Martin-Teaiwa Family: Joan,
 John, Teresia, Katerina
 Sue A. Tempero
 Sri P. TenCate
 Jane Terashima
 Fumio Teruya
 Kanko Teruya
 Gek Ching Thai
 Vilaileka B. Thavornthanasarn
 Tin Myaing Thein
 & Jack Reynolds
 Pirith Thipphavong
 Visith Thipphavong
 John & Mencil Thomas
 The Times Mirror Foundation
 Jan & Helen Ting
 Dr. Parnich Tinnimit
 Lorraine Lorretta Jablonski
 Tobin
 V. Bruce J. Tolentino, PhD
 Shigeo & Kazuko Tonoike
 Mark Torreano
 Hisatsugu Toyoda
 Chau T. Tran
 Lady Tran-Ngoc
 Vijay R. Trehan
 Harry C. Triandis
 Gregory J. Trifonovitch
 Ricardo D. Trimillos
 Dr. & Mrs. Gordon Trockman,
 M.D.
 Dr. & Mrs. Nai K. Tsao
 Charles Tseng
 & Wan-Jen Tseng
 Takashi Tsuchiya
 Etsuko Tsuji
 Beda Tumampos
 Myat T. Tun
 U Maung Maung
 Yukishige Uchida
 Satoshi Ueda
 Hideki Uehara
 Akira Ueno
 Stephen Uhalley
 Hisashi Ujiie
 Junichi Umeda
 Tokiko Umezawa
 US Bancorp Foundation,
 Matching Gifts
 Roy & Fusae Uyemura
 Elizabeth Van Dyke
 Dr. Chamnong Vibulsri
 Sharon W. Villarosa
 Mary J. Wagner
 & Metone S. Wamma
 Shiro Wajima
 Peter W. Walker
 Roland K. W. Wallisch
 Dr. Ute Wallisch-Langlotz
 Bettye S. Walsh
 Ms. Deborah P. Walters
 Jeff & Edna Walters
 Shao-ling V. Wang
 Vincent W. Wang
 Yen Kyun Wang
 Ethel Alikpala Ward
 Representative Gene &
 Faredah Ward
 Noriyuki Watamori
 Shinichi Watanabe
 Indru & Gulab Watumull
 Dr. Susan S. Waugh
 Wei Ke
 Bermin & Phiengphen
 Weillbacher
 Joseph A. Weinstock
 William M. Welch
 Dr. David Wemhaner
 Byong-Sun Whang
 Melton & Ingelia White
 Lynn T. White
 & Barbara-Sue White
 Kenneth E. Williamson
 Carlene Wilson
 Richard W. Wilson
 Cindy Winegar
 Gerhard Winter
 Ms. Arlyne G. de los Santos
 Wollen
 Vivien Wong (Seah)
 Anny Wong & Sara Banaszak
 Patrick Wong
 Timothy C. Wong
 Ta-Cheng Wu
 "Robert" Zhengkang Wu
 Chikanao Yagi
 Matori Yamamoto
 Susumu & Kiiko Yamamoto
 Takashi Yamamoto
 Glenn T. Yamashita
 Michiko M. Yamashita
 Shizuo Yamashita
 Yoshihiko Yamashita
 Tsutomu Yamazaki
 Keiji Yanagisawa
 Huiying Yang
 Serena Hsin-Hsin Yang
 Xiaomei Yang
 Zijin Yang
 Christine R. Yano
 Yasukata Yano
 Mui Teng Yap
 Kichiro Yatomi
 Minho Yeom
 Susan Griffin
 Yasuo Yokota
 Hitomi Yokote
 Jai-Ho Yoo
 Christopher C. York
 Yoshinori Yoshida
 Mimi Beng Poh Yoshikawa
 Dwayne D. Yoshina
 John A. Young
 Dr. Nancy Foon Young
 Peter F. Young
 Janice Yu
 Bernard H. Zandstra
 Arfa S. Zehra
 Peggy & Lee Zeigler
 Henry B. Zuber
 Robert G. Zumwinkle

Conference Participants

This list is for personal use of conference participants only. Please do not share contact data with others or use to send mass emails.

| Last Name | First Name | Preferred Email | Residence |
|----------------|----------------|------------------------------------|----------------|
| ABENOJA | MACRINA | mackiabenoja@hotmail.com | HI, USA |
| ADHIKARYA | RONNY | ronny@RAdhikarya.com | CA, USA |
| AGBAYANI | AMEFIL | agbayani@hawaii.edu | HI, USA |
| AGGARWAL | RAJESH | aggarwalrka@yahoo.com | INDIA |
| AGOES | IRID FARIDA | iagoes@cbn.net.id | INDONESIA |
| ANDERSON | MICHAEL | anderson.michaelh@gmail.com | VA, USA |
| AZRA | AZYUMARDI | azyumardiazra1@gmail.com | INDONESIA |
| BACANI | SELEN | scbacani@yahoo.com | PHILIPPINES |
| BACANI | YOLANDA | scbacani@yahoo.com | PHILIPPINES |
| BANA | KATZ | | INDIA |
| BANA | SAROSH | sarosh.bana@gmail.com | INDIA |
| BAUTISTA | PAULINE ANGELA | pauline@blafi.org | PHILIPPINES |
| BECKER | CHERYL | | |
| BEDI | INGE | inge_bedi@sympatico.ca | CANADA |
| BEDORE | JAMES | james9999@verizon.net | WA, USA |
| BIGALKE | TERRY | bigalket@EastWestCenter.org | HI, USA |
| BROOKEY | FRANCES | fbrookey@yahoo.com | CA, USA |
| BROWN | MANGMANG | brownm@EastWestCenter.org | HI, USA |
| BUCK | ELIZABETH | bettybuck@eastwestcommunity.org | HI, USA |
| BUTT | ATIF I. | Atif.Butt@rub.de | GERMANY |
| CADY | DONA | cadyd@middlesex.mass.edu | MA, USA |
| CHA | JEONGHYE | chakate@gmail.com | USA |
| CHANG | ERIC | Eric.Chang@EastWestCenter.org | HI, USA |
| CHAUDHARY | SUNITA | schaudhary@icimod.org | NEPAL |
| CHEEMA | GHULAM SHABBIR | CheemaS@EastWestCenter.org | HI, USA |
| CHEN | RICHARD | rchen.ict@gmail.com | USA |
| CHO CHO YEE | | chochoyee@gmail.com | MYANMAR |
| CHOI | KAM C. | jimmychoikc@gmail.com | HONG KONG |
| CHONG | KEE-CHAI | keechaichong@eastwestcommunity.org | MALAYSIA |
| CHRISTOFFERSEN | GAYE | gaye_christoffersen@yahoo.com | CA, USA |
| CHU | CINDY | cindychu@hkbu.edu.hk | HONG KONG |
| CHU | RAI SAINT | richturbin@turbin.net | HI, USA |
| COOLEN | PATRICK | PatrickCoolen7@gmail.com | WA, USA |
| COOLEN | PHYLLIS | driver6918@aol.com | WA, USA |
| CORENDEA | COSMIN | ccorendea@stu.edu | FL, USA |
| CULVER | ANNIKA | annika.culver@uncp.edu | NC, USA |
| DAVARI | AZADEH | azadehdavari2009@gmail.com | |
| DETERS | PHILIP | pjdeters@verizon.net | MD, USA |
| DIPPMANN | JEFFREY | Jeffrey.Dippmann@cwu.edu | WA, USA |
| DOLAN | JAMES D. | bama.pjd@gmail.com | TX, USA |
| DOLAN | SUSAN ANNE | bama.pjd@gmail.com | TX, USA |
| DOPTA | DEJI | diki3dopta2003@yahoo.com.cn | MAINLAND CHINA |
| DRYMILLER | DAVID | dpdrymiller@comcast.net | IL, USA |
| EDMOND | ROSIE | redmond@educationusa.info | |
| EGUCHI | CAROLYN | eguchic@EastWestCenter.org | HI, USA |
| EGUCHI | WILBERT | wil.eguchi@gmail.com | HI, USA |
| FELTZ | WILLIAM | FeltzB@EastWestCenter.org | HI, USA |
| FLANIGAN | LYN | lflanigan@hawaii.rr.com | HI, USA |
| FOX | CAROL | foxc@EastWestCenter.org | HI, USA |
| FROGNER | KARL | pattamo_kop@yahoo.com | HI, USA |
| FUJIKI | MERIL | fujikim@EastWestCenter.org | HI, USA |
| FUNG | DANIEL | danfung@dvc.hk | HONG KONG |
| FURUHASHI | SEIKO | seiko@ogu.ac.jp | JAPAN |
| GAO | SONG | gaosong@boaoreview.com | MAINLAND CHINA |
| GEISS | NANCY | ngeiss@att.net | NY, USA |
| GEORGE | TERRENCE | tgeorge@castlefoundation.org | HI, USA |
| GILLIAM | RONALD | rgilliam@hawaii.edu | HI, USA |
| GOHDA | AKINORI | gouda-akino@esnet.ed.jp | JAPAN |
| GONGBU | ZHAXI | gongbuzhaxi@yahoo.com | MAINLAND CHINA |
| GUSTAFSON | DAVID | gus_gustafson@yahoo.com | HI, USA |

CONFERENCE PARTICIPANTS*continued*

| Last Name | First Name | Preferred Email | Residence |
|------------------|-------------------|--------------------------------|-------------------|
| HAJI | KOICHI | haji@nli-research.co.jp | JAPAN |
| HAMAKAWA | CURT | curt.hamakawa@wne.edu | MA, USA |
| HAMMOND | MARY | hammondm@EastWestCenter.org | HI, USA |
| HAQUE | NAJMA | haq_1012002@yahoo.com | BANGLADESH |
| HARA | KIMIE | khara@renison.uwaterloo.ca | CANADA |
| HASEGAWA | NORIKO | hasegawa@hokusei.ac.jp | JAPAN |
| HASHIMOTO | CHIE | chie.hashimoto@guccigroup.com | JAPAN |
| HASSEVOORT | KILEY | james9999@verizon.net | WA, USA |
| HASSEVOORT | MYIAH | james9999@verizon.net | WA, USA |
| HAWKINS | JOHN | hawkins@gseis.ucla.edu | HI, USA |
| HAYAKAWA | IWAO | iwaoh@indigo.plala.or.jp | JAPAN |
| HAYAKAWA | TADAKO | tadako@gmail.plala.or.jp | JAPAN |
| HAZELMAN | FU'A | | THAILAND |
| HAZELMAN | MALCOLM | maldiner@hotmail.com | THAILAND |
| HEFFRON | JOHN | heffron@soka.edu | CA, USA |
| HEFNER | CARL | hefner@hawaii.edu | HI, USA |
| HENDERSON | JAY | jay_henderson@msn.com | MD, USA |
| HENDRATNO | EDIE TOET | edie_toet@yahoo.com | INDONESIA |
| HO | VINH | vttho90@hotmail.com | FL, USA |
| HOR | ANNIE | | |
| HOR | SIN RONG | horsinrong@wanadoo.fr | FRANCE |
| HORAYANGURA | BHANUPHOL | montira1@yahoo.com | THAILAND |
| HUAJUN | GAO | gaohuajun@bnu1.org | MAINLAND CHINA |
| HUNG | FRANK LIANG HAO | frankhung@hpoglobal.com | TAIWAN |
| HUNG | KATHY K. | | TAIWAN |
| IBRAHIM | MUHAMMAD | Mibrahim1946@yahoo.com | PAKISTAN |
| IGP | SURYADARMA | samodhaya@yahoo.com | INDONESIA |
| INA | HISAYOSHI | inahisayoshi@aol.com | JAPAN |
| IR SUHARSO | M. ENG | harso43@yahoo.com | INDONESIA |
| ITOKAZU | JUNKO | itokazu@okilc.org | JAPAN |
| ITOKAZU | MASARU | itokazu@okilc.org | JAPAN |
| JACKSON | RON | ronkanaka@yahoo.com | CA, USA |
| JACOBS | JONATHAN S. | jonnyjacobs@gmail.com | CANADA |
| JANG | JI YOUNG | jjchococat@gmail.com | NH, USA |
| JEONG | NA RAE | jnroiseau@naver.com | REPUBLIC OF KOREA |
| JIN | JINPING | jinjinping@yahoo.com.cn | MAINLAND CHINA |
| JUNG | JISUN | jisun@hku.hk | HONG KONG |
| KANG | XIAOFENG | kangxiaofeng@gmail.com | MAINLAND CHINA |
| KHOIRIATI | SITI DAULAH | daulahk@yahoo.com | INDONESIA |
| KIM | DONGHYUN | dhk296@nyu.edu | NY, USA |
| KIM | HYEON | hj9857@hanmail.net | REPUBLIC OF KOREA |
| KIM | SU YOUN | sykim.asean@gmail.com | REPUBLIC OF KOREA |
| KIM | WON NYON | kwn@korea.ac.kr | REPUBLIC OF KOREA |
| KINJO | SEIKO | s-kinjo@ab.cyberhome.ne.jp | JAPAN |
| KNUDSEN | GREG | knudsen123@gmail.com | HI, USA |
| KNUDSEN | KAREN | Knudsen@EastWestCenter.org | HI, USA |
| KOYANAGI | KEETHE TAIRA | kkoyanagi@fhn.com | HI, USA |
| KUME | TERUYUKI | kume@rikkyo.ac.jp | JAPAN |
| LAI | DER LIANG | lilijen@ms21.hinet.net | TAIWAN |
| LARSON | BETTY LOU | alohabettylou@hotmail.com | HI, USA |
| LATIF | YUDI | yudi.latif@yahoo.co.id | INDONESIA |
| LAU | ANDY | andybec@ciyss.org | MAINLAND CHINA |
| LAU | FREDERICK | fredlau@hawaii.edu | HI, USA |
| LEE | DOO WON | leedw104@yonsei.ac.krf | REPUBLIC OF KOREA |
| LEE | HONG GU | honlee92@gmail.com | IL, USA |
| LEE | JAE HYUN | victor@primenj.org | NJ, USA |
| LEE | MOLLY NYET NGO | mlmollylee@gmail.com | MALAYSIA |
| LEE | WONSEOK | 911ryan@naver.com | MA, USA |
| LEWIS | NANCY | Nancy.Lewis@EastWestCenter.org | HI, USA |
| LI | FAN | FanLi73@gmail.com | HI, USA |

CONFERENCE PARTICIPANTS*continued*

| Last Name | First Name | Preferred Email | Residence |
|-----------------------|-------------------|----------------------------------|-------------------|
| LI | JIN LAN | ifpljl@hotmail.com | MAINLAND CHINA |
| LI | LUSI | lilusi@sinfrench.com | MAINLAND CHINA |
| LI | MINGBO | limingbo1980@126.com | MAINLAND CHINA |
| LI | SHANGBO | shangboi@obirin.ac.jp | JAPAN |
| LIMAYE | SATU | limayes@EastWestCenter.org | DC, USA |
| LINDBERG | STIG | stigberg1@netscape.net | HI, USA |
| LINDSEY | LINDA | llindsey@wustl.edu | MO, USA |
| LITTLEJOHN | RONNIE | ronnie.littlejohn@belmont.edu | TN, USA |
| LIU | BINGHUA | binghua@bnu1.org | MAINLAND CHINA |
| LOUGHLIN | PHILIP | PHLoughlin@aol.com | MA, USA |
| MA | WANHUA | hma@pku.edu.cn | MAINLAND CHINA |
| MASKE | NIRENDRA | ndmaske@hotmail.com | NEPAL |
| MATSUDA | YOKO | matsuda@econ.u-hyogo.ac.jp | JAPAN |
| MATSUMOTO | TETSUJI | matsumotot@eastwestcommunity.org | JAPAN |
| MATSUNAGA | MAURICE | Maurice.matsunaga@va/gov | HI, USA |
| MATSUNAGA | PATRICIA | matsunap@EastWestCenter.org | HI, USA |
| MEDALLA | FRANCIS CONRAD | | |
| MEDALLA | JOEY | | |
| MEDALLA | KAREN | | |
| MEDALLA | LENNIE | | |
| MOK | KA HO | kahomok@ied.edu.hk | HONG KONG |
| MORRIS | PETER | alohapeter@gmail.com | WA, USA |
| MORRISON | CHARLES | morrisoc@EastWestCenter.org | HI, USA |
| MUNINJAYA | AGUNG | munin07@unud.ac.id | INDONESIA |
| MURAKAMI | YOSHIKAZU | yoshi-1@yacht.ocn.ne.jp | JAPAN |
| MURAO | JUN | hokutohitiseijp@yahoo.co.jp | JAPAN |
| NAKACHI | KIYOSHI | k.nakachi@meio-u.ac.jp | JAPAN |
| NAMGOONG | CHAN | namgoong@mbc.co.kr | REPUBLIC OF KOREA |
| NANZAO | ZHOU | zhounz@hotmail.com | MAINLAND CHINA |
| NEUBAUER | DEANE | deanen@hawaii.edu | HI, USA |
| NISHIHIRA | FUMIKO | fuminishi42@yahoo.co.jp | JAPAN |
| NISHIHIRA | ISAO | fuminishi42@yahoo.co.jp | JAPAN |
| NITTA | FUMITERU | nitta6669@yahoo.co.jp | JAPAN |
| NONIN | TAKASHI | nonint@coffee.ocn.ne.jp | JAPAN |
| OLIVE | CRISTINA | solive@usaid.gov | USA |
| OLIVE | KEKOA | | USA |
| OLIVE | STEVEN | gigiolive@yahoo.com | USA |
| ORDONEZ | REGINA | GINAQLI@yahoo.com | PHILIPPINES |
| OVITT | REBECCA | rovitt@hba.net | HI, USA |
| PALMORE | SUSAN | susanmpalmore@yahoo.com | HI, USA |
| PERUSHEK | D. E. | perushek@hawaii.edu | HI, USA |
| PETERS | DARLENE | joseph.peters@chaminade.edu | HI, USA |
| PETERS | JOSEPH | joseph.peters@chaminade.edu | HI, USA |
| POH | KOK | kokkianp@gmail.com | MALAYSIA |
| RAJAMANI | SIVA SAKTHIRAJ | siva.sakthiraj@gmail.com | INDIA |
| RAMLER | SIEGFRIED | ramlers001@hawaii.rr.com | HI, USA |
| RATLIFFE | KATHERINE | ratliffe@hawaii.edu | HI, USA |
| REKSODIPUTRO | MARDJONO | mreksodiputro@abnrlaw.com | INDONESIA |
| REKSODIPUTRO | NASTI | mardjono@cbn.net.id | INDONESIA |
| RICHARDS | LEON | lr24@hawaii.edu | HI, USA |
| ROLLES | JEAN ESTELLE | jean.rolles@outrigger.com | HI, USA |
| SABIQ | AHMAD | sabiq_ahmad@yahoo.com | INDONESIA |
| SAIGNASITH | CHANTHAVONG | chanthavongsa@live.com | LAO PDR |
| SALMON, JR. | CHARLES | salmonc@apcss.org | HI, USA |
| SAMARANAYAKE-ROBINSON | WYLMA | wylma@waikikiwyl.me | HI, USA |
| SANANIKONE | PUONGPUN | ppsananikone@yahoo.com | HI, USA |
| SANANIKONE | THANH-LO | taf@tafinternational.com | HI, USA |
| SARWAR | IMRAN | ls11pakistan@yahoo.com | PAKISTAN |
| SEAGULL | LEWIS | lewseagull@aol.com | NJ, USA |
| SENG | SEOK HOON ALICE | Seokhoon.seng.nie.edu.sg | SINGAPORE |

CONFERENCE PARTICIPANTS*continued*

| Last Name | First Name | Preferred Email | Residence |
|------------------|-------------------|------------------------------|-------------------|
| SHAMBAUGH | VICKI | vshambaugh@phrei.org | HI, USA |
| SHEETZ-NGUYEN | JESSICA | JSheetzNguyen@uco.edu | OK, USA |
| SHIBUYA | MOMOYO | shibuya@mall.saitama-u.ac.jp | JAPAN |
| SHIN | JUNG-CHEOL | jcs6205@snu.ac.kr | REPUBLIC OF KOREA |
| SHIVE | GLENN | glennshive@cuhk.edu.hk | HONG KONG |
| SHULTZ | EDWARD | shultz@hawaii.edu | HI, USA |
| SIDDALL | DOROTHY | ronkanaka@yahoo.com | CA, USA |
| SIDEL | MARK | sidel@wisc.edu | WI, USA |
| SMITH-NORRIS | MARTHA | martha.smith-norris@usask.ca | CANADA |
| STEELE | TRACY | his_tls@yahoo.com | TX, USA |
| STEINEMANN | NAMJI | steinemn@EastWestCenter.org | HI, USA |
| STICE | APOLONIA AGONoy | apol@lava.net | HI, USA |
| STICE | GARY | apol@lava.net | HI, USA |
| STUMPH | BARBARA BORNET | bbornets@yahoo.com | CA, USA |
| SUTANTO | JUSUF | Jusuf_sw@yahoo.co.id | INDONESIA |
| SUZUKI | ITSUKO | imasudasuzuki@hawaii.rr.com | HI, USA |
| SUZUKI | MITSUAKI | msuzuki@hawaii.edu | HI, USA |
| TAI | RAYMOND R. M. | rmtai721@gmail.com | TAIWAN |
| TANOUE | NOREEN | tanouyen@EastWestCenter.org | HI, USA |
| THAMBIPILLAI | PUSHPATHAVI | ppathambi@yahoo.com | SINGAPORE |
| THORSTEN | MARIE | thorstema@hotmail.com | HI, USA |
| TITALEY | JOHN | j_titaley@yahoo.com | INDONESIA |
| TOLENTINO | V. BRUCE | bruce.tolentino@gmail.com | PHILIPPINES |
| TRIMILLOS | RICARDO | rtrimil@hawaii.edu | HI, USA |
| TROYAKOVA | TAMARA | tamaratroyakova@gmail.com | RUSSIA |
| TSENG | CHARLES | charles_tseng80@hotmail.com | IL, USA |
| TSENG | WAN-JEN | charles_tseng80@hotmail.com | IL, USA |
| TSUJIMURA | R. BRIAN | rtsujimura@imanakakudo.com | HI, USA |
| TSUJIMURA | RUTH | | HI, USA |
| TU | WEIMING | wtu@fas.harvard.edu | MAINLAND CHINA |
| TURBIN | RICHARD | richturbin@turbin.net | HI, USA |
| VIGOD | MICHELLE | mvigod@hotmail.com | CANADA |
| WANG | JILI | luckyking888@yahoo.com.cn | MAINLAND CHINA |
| WANG | MIN | wm@xmu.edu.cn | MAINLAND CHINA |
| WANG | QING HONG | wangq@EastWestCenter.org | HI, USA |
| WANG | YEN-KYUN | ykwang@cau.ac.kr | REPUBLIC OF KOREA |
| WANG | ZHENYAO | wzhy@bnu1.org | MAINLAND CHINA |
| WEBER | JOAN | jweber@scarsdaleschools.org | NY, USA |
| WEN | HAIMING | wenhaiming@gmail.com | MAINLAND CHINA |
| WIJEWANSA | RANJIT ASOKA | alfiewije@gmail.com | SRI LANKA |
| WILBUR | COLBURN | CWilbur@packard.org | CA, USA |
| WONG | RANDALL | wongrsj@hotmail.com | HI, USA |
| WONG | VALERIE | wongv@EastWestCenter.org | HI, USA |
| WU | I KANG | cowwsikw@netvigator.com | HONG KONG |
| WYNDHAM | CAITLIN | cmwyndham@gmail.com | AUSTRALIA |
| XU | JING | jenniexu@ucla.edu | CA, USA |
| YAMAZATO | KEIKO | yamazato@ocjc.ac.jp | JAPAN |
| YAN | MICHEAL | | MAINLAND CHINA |
| YANG | YONGSHENG | yysart@163.com | MAINLAND CHINA |
| YANG | MING | yangming@hawaii.edu | HI, USA |
| YEN | LI HUA | liliyen@ms21.hinet.net | TAIWAN |
| YEOM | MINHO | minho@jnu.ac.kr | REPUBLIC OF KOREA |
| YONEYAMA | ASAJI | yoneyama@ecatv.home.ne.jp | JAPAN |
| YONG | YOK-SEE | | |
| YOON | JI HEE | jayy.1994@gmail.com | CT, USA |
| YOONG | LEE-LIAN | | |
| YOONG | LI-FOONG | | |
| YOSHIDA | GARY | YoshidaG@EastWestCenter.org | HI, USA |
| ZEHRA | ARFA | arfa_zehra@yahoo.com | PAKISTAN |

Panel Presenters and Moderators

This list is for personal use of conference participants only. Please do not share contact data with others or use to send mass emails.

AGGARWAL, RAJESH, Associate Professor, Centre for Research in Rural and Industrial Development, INDIA, aggarwalrka@yahoo.com

AGOES, IRID, Chair of the American Studies Graduate Program, University of Indonesia and Chair of the Asia Pacific Development Foundation, INDONESIA, iagoes@cbn.net.id

AZRA, AZYUMARDI, Director, Graduate School, Syarif Hidayatullah State Islamic University, INDONESIA, azyumardiazra1@gmail.com

BAUTISTA, PAULINE ANGELA, Corporate Secretary, Bagong Lumad Artists Foundation Inc., PHILIPPINES, pauline@blafi.org

BUTT, ATIF IKRAM, PhD Fellow, Ruhr University Bochum, GERMANY, Atif.Butt@ruhr-uni-bochum.de

CADY, DONA, Associate Dean of Humanities and Asian Studies, Middlesex Community College, USA, cadyd@middlesex.mass.edu

CHANG, ERIC, Program Assistant, Arts Program, East-West Center, USA, ChangE@eastwestcenter.org

CHAUDHARY, SUNITA, Research Associate, International Centre for Integrated Mountain Development, NEPAL, schaudhary@icimod.org

CHEEMA, SHABBIR, Senior Fellow, East-West Center and Director, Asia-Pacific Governance and Democracy Initiative, USA, CheemaS@eastwestcenter.org

CHEN, RICHARD TEH-KAI, USA, rchen.ict@gmail.com

CHOI, KAM CHUEN, Part-time Lecturer, Baptist University, HONG KONG, jimmychoikc@gmail.com

CHRISTOFFERSEN, GAYE, Visiting Associate Professor, Johns Hopkins University, USA, gchris14@jhu.edu

CHU, CINDY, Professor, Hong Kong Baptist University, HONG KONG, cindychu@hkbu.edu.hk

COOLEN, PATRICK, MS, USA, patrickcoolen7@gmail.com

COOLEN, PHYLLIS, RN, MSN, DNP, USA, driver6918@aol.com

CORENDEA, COSMIN, Associate Academic Officer, United Nations University, USA, corendea@ehs.unu.edu

CULVER, ANNIKA, Asst. Professor of Asian History, University of North Carolina, USA, annika.culver@uncp.edu

DAVARI, AZADEH, Leadership and FNS trainer and researcher, The Leadership Group, IRAN, azadehdavari2009@gmail.com

DIPPMAN, JEFFREY, Associate Professor, Central Washington University, USA, Jeffrey.Dippmann@cwu.edu

FELTZ, WILLIAM, Manager, Arts Program, East-West Center, USA, FeltzB@eastwestcenter.org

FOX, CAROL, Director for Special Projects, East-West Center, USA, foxc@eastwestcenter.org

FROGNER, KARL, President & Project Development Head, UB International, USA, pattamo_kop@yahoo.com

FUJIKI, MERIL, Seminars Development Coordinator, East-West Center, USA, FujikiM@eastwestcenter.org

FUNG, DANIEL R., SBS, SC, QC, JP, Des Voeux Chambers, HONG KONG, danfung@dvc.hk

HAMAKAWA, CURT, Associate Professor of Sport Management, Western New England University, USA, curt.hamakawa@wne.edu

HARA, KIMIE, Professor, Renison Research Professor, University of Waterloo, CANADA, khara@uwaterloo.ca

HAWKINS, JOHN, Senior Consultant, East-West Center, USA, hawkins@gseis.ucla.edu

HEFFRON, JAY, Associate Director, Pacific Basin Research Center, Soka University of America, USA, heffron@soka.edu

HENDERSON, JAY, USA, jay_henderson@msn.com

HENDRATNO, EDIE TOET, Rector, University of Pancasila, INDONESIA, edie_toet@yahoo.com

HIDAYAT, KOMARUDDIN, Rector, Syarif Hidayatullah State Islamic University, INDONESIA, komaruddinhidayat@yahoo.com

IBRAHIM, MUHAMMAD, PAKISTAN, Mibrahim1946@yahoo.com

ITOKAZU, JUNKO, Director, NPO Okinawa Language Center, JAPAN, itokazu@okilc.org

JANG, JI YOUNG, Student, Phillips Exeter Academy, USA, jjjang@exeter.edu

JEONG, NARAE, REPUBLIC OF KOREA, jnroiseau@naver.com

JIN, JINPING, Director, Nonprofit Organization Law Research Center, Peking University, MAINLAND CHINA, jinjinping@yahoo.com.cn

KAM, MARCUS, Director, T3 International Limited, MAINLAND CHINA, marcus@tomsan.com

KHOIRIATI, SITI DAULAH, Gajah Mada University, INDONESIA, daulahk@yahoo.com

KIM, DONGHYUN, Graduate Student, New York University, USA, dhk296@nyu.edu

PANEL PRESENTERS AND MODERATORS

continued

KIM, HYEON JEONG, REPUBLIC OF KOREA,
hj9857@hanmail.net

KIM, SU YOUN, Officer, ASEAN-Korea Centre, REPUBLIC OF KOREA, sykim.asean@gmail.com

KIM, WON NYON, Professor, Korea University, REPUBLIC OF KOREA, kwn@korea.ac.kr

KINJO, SEIKO, Teacher, Ishida Junior High School, JAPAN, s-kinjo@ab.cyberhome.ne.jp

KUME, TERUYUKI, Professor, Rikkyo University, JAPAN, kume@rikkyo.ac.jp

LATIF, YUDI, Center for Pancasila Studies, University of Pancasila, INDONESIA, yudi.latif@yahoo.co.id

LAU, FREDERICK, PhD, University of Hawai'i, USA, fredlau@hawaii.edu

LEE, HONG GU, Student, University of Chicago, USA, honlee92@gmail.com

LEE, JAE HYUN, Director, Prime Education Consulting, USA, victor@primenj.org

LEE, MOLLY N.N., Programme Specialist, UNESCO Asia and the Pacific Regional Bureau for Education in Bangkok, MALAYSIA, mlmollylee@gmail.com

LEE, WONSEOK, Student, Governor's Academy, USA, 911ryan@naver.com

LEWIS, NANCY, Director, Research Program, East-West Center, USA, lewisn@eastwestcenter.org

LI, SHANGBO, Assistant Professor, J.F.Oberlin University, JAPAN, shangboi@obirin.ac.jp

LINDBERG, STIG, PhD Candidate, Kyoto University, JAPAN, stigberg1@gmail.com

LINDSEY, LINDA, Senior Lecturer, American Culture Studies, Washington University in St. Louis, USA, llindsey@artsci.wustl.edu

LITTLEJOHN, RONNIE, Chair, Department of Philosophy, Belmont University, USA, ronnie.littlejohn@belmont.edu

MA, WANHUA, Professor, Graduate School of Education, Peking University, MAINLAND CHINA, hma@pku.edu.cn

MATSUDA, YOKO, Professor, University of Hyogo, JAPAN, yokomat@gmail.com

MOK, KA HO, Associate VP (External Relations) and Dean of Faculty of Arts and Sciences, The Hong Kong Institute of Education, HONG KONG, kahomok@ied.edu.hk

MUNINJAYA, AGUNG, Director, The Center of Health Services Management, Udayana University, INDONESIA, munin07@unud.ac.id

MURAKAMI, YOSHIKAZU, Lecturer, Ehime University, JAPAN, yoshi-1@yacht.ocn.ne.jp

NAKACHI, KIYOSHI, Meio University, JAPAN, k.nakachi@meio-u.ac.jp

NEUBAUER, DEANE, Senior Consultant, Education Program, East-West Center, USA, deanen@hawaii.edu

PETERS, DARLENE, Instructor, Chaminade University, USA, pdarlenepeters@gmail.com

PETERS, JOSEPH, Dean, Education Division, Chaminade University, USA, joseph.peters@chaminade.edu

RAJAMANI, SIVA SAKTHIRAJ, Climate Change and Sustainability Advisor, Ernst & Young, INDIA, siva.sakthiraj@gmail.com

RAMLER, SIEGFRIED, Senior Adjunct Fellow, East-West Center, USA, ramlers001@hawaii.rr.com

RASHIDI, ARASH, Research Assistant Professor, National Nutrition and Food Technology Research Institute, IRAN, a.rashidi@nnftri.ac.ir

RATLIFFE, KATHERINE, Associate Professor, University of Hawai'i, USA, ratliffe@hawaii.edu

SABIQ, AHMAD, Head of Department of Political Science, Jenderal Soedirman University, INDONESIA, sabiq_ahmad@yahoo.com

SALIM, WILMAR, Assistant Professor, Bandung Institute of Technology, INDONESIA, wsalim@pl.itb.ac.id

SAMARANAYAKE-ROBINSON, WYLMA, Faculty, University of Phoenix, USA, wylma@waikikiwyl.me

SARWAR, CHAUDHARY IMRAN, Creative Researcher, Mixed Reality University, PAKISTAN, is11pakistan@yahoo.com

SEAGULL, LEWIS, Adjunct Professor, Kean University, USA, lseagull@kean.edu

SHAMBAUGH, VICKI, Director, Research and Development, Pacific Health Research and Education Institute, USA, vlshambaugh@phrei.org

SHEETZ-NGUYEN, JESSICA, Associate Professor of History, University of Central Oklahoma, USA, JSheetzNguyen@uco.edu

SHIBUYA, MOMOYO, Associate Professor, Saitama University, JAPAN, shibuya@mail.saitama-u.ac.jp

SHIN, JUNG-CHEOL, Associate Professor, Seoul National University, REPUBLIC OF KOREA, jcs6205@snu.ac.kr

SHIVE, GLENN, Executive Director, Hong Kong America Center, HONG KONG, glennshive@cuhk.edu.hk

PANEL PRESENTERS AND MODERATORS

continued

SIDEL, MARK, Doyle-Bascom Professor of Law, University of Wisconsin-Madison, USA

SMITH-NORRIS, MARTHA, Associate Professor, University of Saskatchewan, CANADA, martha.smith-norris@usask.ca

STEELE, TRACY, Associate Professor, Sam Houston State University, USA, his_tls@yahoo.com

STEINEMANN, NAMJI, Associate Director Education Program, East-West Center, USA, steinemn@eastwestcenter.org

STUMPH, BARBARA BORNET, Teacher, Author, Artist, USA, bbornets@yahoo.com

SURYADARMA, Lecturer, Hindu University, INDONESIA, samodhaya@yahoo.com

SURYANDI, NYANA, Buddhayana, INDONESIA, psnadi@gmail.com

SUTANTO, JUSUF, Lecturer, University of Pancasila, Faculty of Psychology and Associate Researcher, University of Indonesia, Psychology Research Center, INDONESIA, jusuf_sw@yahoo.co.id

THAMBIPILLAI, PUSHPA, Visiting Senior Research Fellow, Institute of Southeast Asian Studies, SINGAPORE, pushpa.thambipillai@hotmail.com

TITALEY, JOHN, Rector, Satya Wacana Christian University, INDONESIA, j_titaley@yahoo.com

TOLENTINO, V. BRUCE J., Deputy Director-General, International Rice Research Institute, PHILIPPINES, b.tolentino@irri.org

TRIMILLOS, RICARDO, President, East-West Center Association, USA, rtrimil@hawaii.edu

TROYAKOVA, TAMARA, Associate Professor, Far Eastern Federal University, RUSSIA, tamaratroyakova@gmail.com

WANG, MIN, Professor, Xiamen University, MAINLAND CHINA, wm@xmu.edu.cn

WANG, YEN-KYUN, Visiting Professor, Hoseo University, REPUBLIC OF KOREA, ykwang@cau.ac.kr

WANG, ZHENYAO, President, China Philanthropy Research Institute, MAINLAND CHINA, wzhy@bnu1.org

WIRYONO P SJ, PAULUS, Rector, Sanata Dharma University, INDONESIA, pwiryono@jesuits.net

WYNDHAM, CAITLIN, AUSTRALIA, cmwyndham@gmail.com

XU, JING, PhD Candidate, University of California, Los Angeles, USA, jenniexu@ucla.edu

YAMAZATO, KEIKO, Professor, Okinawa Christian University, JAPAN, yamazato@ocjc.ac.jp

YANG, MING, Degree Fellow, East-West Center, USA, yangming@hawaii.edu

YEOM, MINHO, Professor, Chonnam National University, REPUBLIC OF KOREA, minho@jnu.ac.kr

YOON, JI HEE, Student, Loomis Chaffee School, USA, jayy.1994@gmail.com

YOSHIDA, GARY, Foundation Development Officer, East-West Center, USA, YoshidaG@eastwestcenter.org

ZEHR, ARFA, Professor, Forman Christian College, PAKISTAN, arfazehra@gmail.com

ZHOU, NANZHAO, President, International Center of Teacher Education and Professor, East China Normal University, MAINLAND CHINA, zhounz@hotmail.com

Campus Map of Peking University

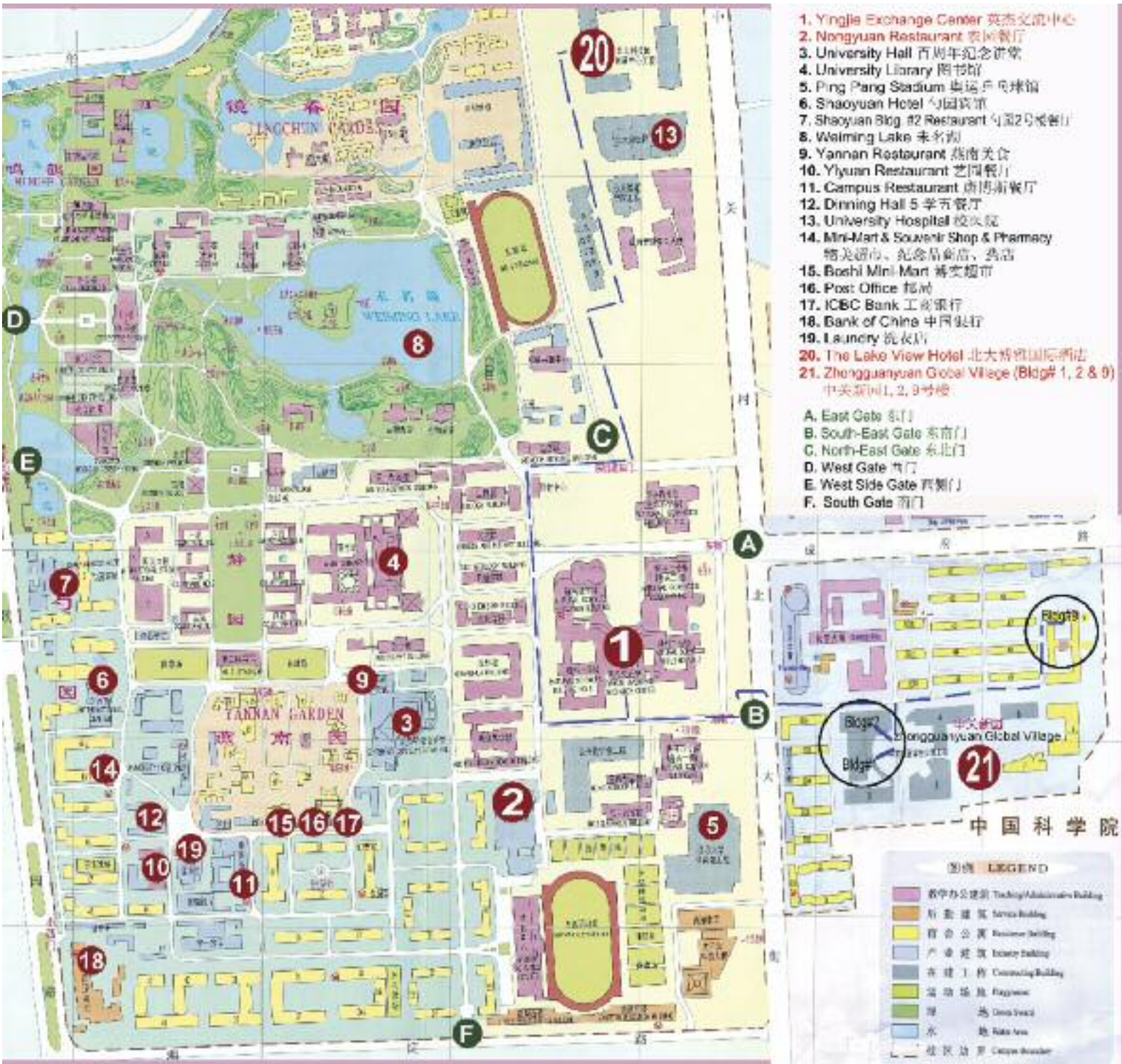



EAST-WEST CENTER
COLLABORATION • EXPERTISE • LEADERSHIP

EastWestCenter.org

1601 East-West Road, Honolulu, Hawai'i 96848-1601
Tel: 808.944.7111 | Fax: 808.944.7376
EWCInfo@EastWestCenter.org



The East-West Center promotes better relations and understanding among the people and nations of the United States, Asia and the Pacific through cooperative study, research and dialogue. Established by the US Congress in 1960, the Center serves as a resource for information and analysis on critical issues of common concern, bringing people together to exchange views, build expertise and develop policy options.

Officially known as the Center for Cultural and Technical Interchange between East and West, the Center is a US-based institution for public diplomacy with international governance, staffing, students and participants.

The Center is an independent, public, nonprofit organization with funding from the US government, and additional support provided by private agencies, individuals, foundations, corporations and governments in the region.

The Center's 21-acre Honolulu campus, adjacent to the University of Hawai'i at Mānoa, is located midway between Asia and the US mainland and features research, residential and international conference facilities. The Center's Washington, D.C. office focuses on preparing the United States for an era of growing Asia Pacific prominence.